

CITY OF PLEASANTON

PUBLIC WORKS DEPARTMENT

ANNUAL CURB AND GUTTER FOR STREET RESURFACING PROJECTS - CIP NO. 25509

BID SET, DECEMBER 2024

LOCATION MAP

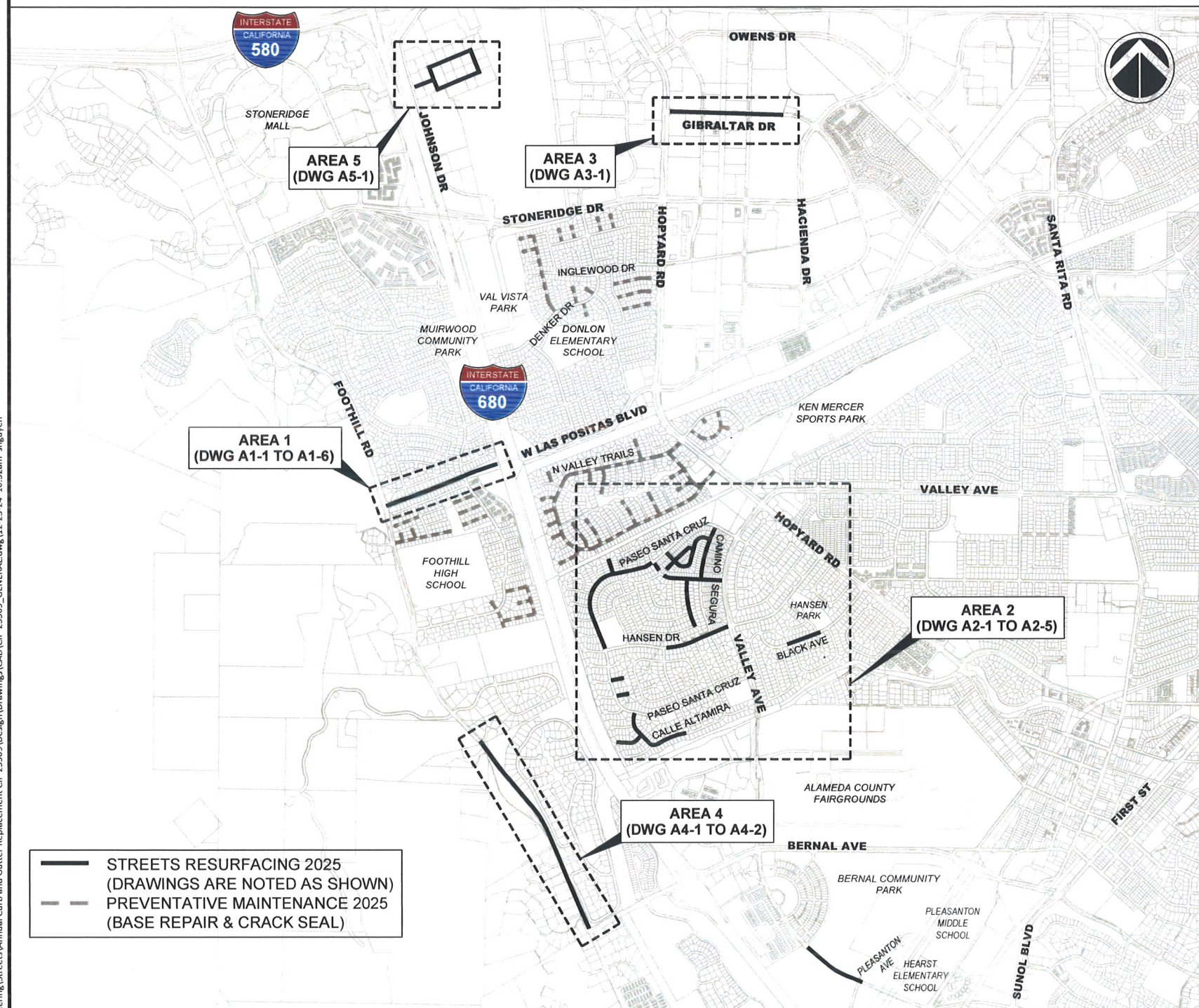

STREETS RESURFACING 2025
 (DRAWINGS ARE NOTED AS SHOWN)
 PREVENTATIVE MAINTENANCE 2025
 (BASE REPAIR & CRACK SEAL)

SHEET INDEX

SHEET NO.	DRAWING NO.	DESCRIPTION
1	G-1	TITLE SHEET, LOCATION MAP AND SHEET INDEX
2	G-2	GENERAL NOTES AND DETAILS
3	G-3	STANDARD RAMP DETAILS
4	G-4	POLLUTION PREVENTION PLAN
5	A1-1	WEST LAS POSITAS BOULEVARD STA 0+00 TO STA 4+97
6	A1-2	WEST LAS POSITAS BOULEVARD STA 12+00 TO STA 16+69
7	A1-3	WEST LAS POSITAS BOULEVARD AND FOOTHILL ROAD NORTH RAMP DETAIL
8	A1-4	WEST LAS POSITAS BOULEVARD AND FOOTHILL ROAD SOUTH RAMP DETAIL
9	A1-5	WEST LAS POSITAS BOULEVARD AND LAKEWOOD STREET RAMP DETAILS
10	A1-6	WEST LAS POSITAS BOULEVARD AND MUIRWOOD DRIVE RAMP DETAILS
11	A2-1	CAMINO DEL LAGO, CAMINO SEGURA, CAMINO DEL CINO, COURTE DEL CINO, PASEO SANTA CRUZ AND VIA DE LOS CERROS
12	A2-2	PASEO SANTA CRUZ AND CORTE DEL VISTA
13	A2-3	CAMINO SEGURA, CALLE DE LA LOMA AND VIA DE LOS CERROS
14	A2-4	CALLE DE LA LOMA AND HANSEN DRIVE
15	A2-5	BLACK AVENUE, CALLE ALTAMIRA AND CORTE MATEO
16	A3-1	GIBRALTAR DRIVE
17	A4-1	FOOTHILL ROAD
18	A4-2	FOOTHILL ROAD RAMP DETAIL
19	A5-1	COMMERCE CIRCLE

ABBREVIATIONS

AB	AGGREGATE BASE	DET	DETAIL	LOG	LIP OF GUTTER	ST	STREET
AC	ASPHALT CONCRETE	DI	DRAIN INLET	LF	LINEAR FEET	STD	STANDARD
AVE	AVENUE	DR	DRIVE	LS	LANDSCAPE	S/W	SIDEWALK
BOC	BACK OF CURB	D/W	DRIVEWAY	MAX	MAXIMUM	TOC	TOP OF CURB
BL/BLVD	BOULEVARD	EA	EACH	MIN	MINIMUM	TS	TRAFFIC SIGNAL
BM	BENCH MARK	EP	EDGE OF PAVEMENT	MH	MAN HOLE	TYP	TYPICAL
BSW	BACK OF SIDEWALK	EX	EXISTING	NTS	NOT TO SCALE	VG	VALLEY GUTTER
CP	CONTROL POINT	FOC	FACE OF CURB	OS	OVERSIZED	WM	WATER METER
C/G	CURB AND GUTTER	FH	FIRE HYDRANT	PAV	PAVEMENT	WV	WATER VALVE
CIR	CIRCLE	FL	FLOW LINE	R	RADIUS	W/	WITH
CT	COURT	FT	FEET	RD	ROAD	"	INCH
C/L	CENTERLINE	GB	GRADE BREAK	R/W	RIGHT-OF-WAY	'	FEET
DWG	DRAWING	HMA	HOT MIX ASPHALT	R/R	REMOVE AND REPLACE	@	AT
				SF	SQUARE FEET		

LEGEND

RIGHT OF WAY	EX. TRAFFIC SIGNAL BOX
EX. ELEVATION	EX. PACIFIC GAS & ELECTRIC UTILITY BOX
PROPOSED ELEVATION	EX. UTILITY BOX
EX. FIRE HYDRANT	
EX. TREE	

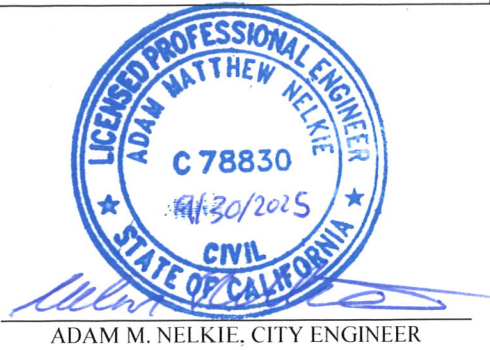

\\delucchi\pw\Engineering\Streets\Annual Curb and Gutter Replacement CIP-25509\Drawings\CAD\CIP-25509_GENERAL.dwg 12-23-24 10:32am srnguyen

GENERAL NOTES

- ALL MATERIAL AND WORKMANSHIP SHALL FULLY CONFORM WITH THE SPECIFICATIONS, STANDARDS AND ORDINANCES OF THE CITY OF PLEASANTON. STANDARD SPECIFICATIONS AND DETAILS ARE AVAILABLE AT THE PUBLIC WORKS DEPARTMENT.
- THE PUBLIC WORKS DEPARTMENT (925-931-5650) SHALL BE NOTIFIED 24 HOURS PRIOR TO THE START OF ANY WORK BY THE CONTRACTOR OR SUBCONTRACTORS.
- THE OFFICE OF PUBLIC WORKS INSPECTION (925-931-5690) SHALL BE NOTIFIED 24 HOURS PRIOR TO THE START OF ANY WORK BY THE CONTRACTOR OR SUBCONTRACTORS.
- IT SHALL BE THE CONTRACTOR'S RESPONSIBILITY TO DETERMINE THE EXISTENCE AND LOCATION OF ALL UNDERGROUND UTILITIES. THE CONTRACTOR SHALL NOTIFY UTILITY COMPANIES 48 HOURS PRIOR TO CONSTRUCTION TO FIELD LOCATE UTILITIES. CONTACT UNDERGROUND SERVICE ALERT AT 800-642-2444. ANY ADDED COST ON THE PART OF THE CONTRACTOR AS A RESULT OF THE ACTUAL LOCATION OF EXISTING UTILITIES BEING DIFFERENT FROM THOSE SHOWN ON THE PLANS SHALL BE BORNE BY THE CONTRACTOR AND ASSUMED INCLUDED IN THE CONTRACT UNIT PRICE.
- THE CONTRACTOR SHALL BE HELD RESPONSIBLE FOR ANY FIELD CHANGES MADE WITHOUT WRITTEN AUTHORIZATION FROM THE CITY ENGINEER.
- ALL QUANTITIES AND PAY ITEMS ARE AND WILL BE BASED ON HORIZONTAL MEASUREMENTS.
- CONTRACTOR SHALL PROVIDE TRAFFIC AND PEDESTRIAN CONTROL INCLUDING FLAG PERSONS PER SPECIFICATIONS AND SHALL SUBMIT A TRAFFIC CONTROL PLAN SUBJECT TO THE APPROVAL OF THE CITY ENGINEER PRIOR TO THE START OF WORK.
- ALL EXISTING UTILITIES AND PRIVATE IMPROVEMENTS THAT BECOME DAMAGED DURING CONSTRUCTION SHALL BE COMPLETELY RESTORED TO THE SATISFACTION OF THE CITY ENGINEER, AT CONTRACTOR'S SOLE EXPENSE.
- SAFETY MEASURES: AT ALL TIMES THE CONTRACTOR SHALL BE SOLELY AND COMPLETELY RESPONSIBLE FOR CONDITIONS OF THE JOB SITE INCLUDING SAFETY OF PERSONS AND PROPERTY. (THIS REQUIREMENT SHALL APPLY CONTINUOUSLY AND NOT JUST DURING NORMAL WORKING HOURS) AND FOR ALL NECESSARY INDEPENDENT ENGINEERING REVIEWS OF THESE CONDITIONS. THE ENGINEER'S JOB SITE REVIEW IS NOT INTENDED TO INCLUDE REVIEW OF THE ADEQUACY OF THE CONTRACTOR'S SAFETY MEASURES.
- ALL STRIPING AND PAVEMENT LEGENDS INCLUDING ARROWS SHALL BE PAINT MATCHING EXISTING COLOR UNLESS OTHERWISE SPECIFIED ON THESE PLANS OR DIRECTED BY THE ENGINEER.
- CONTRACTOR SHALL NOTIFY ALL TRANSPORTATION COMPANIES, GARBAGE SERVICE, AND POST OFFICE OF PAVING SCHEDULE TO ALLOW COORDINATION. POST OFFICE (925-846-5631), GARBAGE SERVICE (925-846-2042).
- THE CONTRACTOR SHALL PREPARE AND DISTRIBUTE A "GOOD NEIGHBOR LETTER" ADVISING EACH RESIDENCE 48 HOURS PRIOR TO BEGINNING THE WORK.
- REFERENCE TO THE STATE STANDARD SPECIFICATIONS AND STANDARD PLANS MEANS THE MAY 2023 EDITIONS.
- CONTRACTOR SHALL REMOVE U.S.A. MARKING.
- BACKGROUND AERIAL PROVIDED ON THE PROJECT PLANS IS FOR INFORMATION PURPOSES ONLY.
- HAUL ROUTE: (AS APPROVED BY THE PROJECT INSPECTOR).
- ALL ROAD MEASUREMENTS ARE TAKEN FROM FACE OF CURB TO FACE OF CURB.
- WORK SHOWN ON PLANS FOR ADA RAMPS DO NOT REFLECT REMOVAL AND REPLACEMENT TO THE NEAREST SCOREMARK. EXPAND AS NECESSARY TO REMOVE EXISTING 12" GROOVE DETAIL AT TOP OF EXISTING WINGS.
- WORK SHOWN ON PLANS FOR CURB AND GUTTER REMOVAL AND REPLACEMENT DO NOT REFLECT ACTUAL REMOVALS AND SHALL BE PER CITY'S REVIEW AND APPROVED LIMITS AFTER CONTRACTOR'S SURVEY.
- TREES IDENTIFIED FOR ROOT INSPECTION BY CITY ARBORIST SHALL BE COORDINATED A MINIMUM OF 48 HOURS PRIOR TO CONCRETE REMOVAL. INSPECTION CAN NOT OCCUR UNTIL AFTER CONCRETE HAS BEEN REMOVED AND ROOTS 2" IN DIAMETER OR GREATER TO BE REMOVED/GRIND ARE MARKED WITH PAINT BY CONTRACTOR.

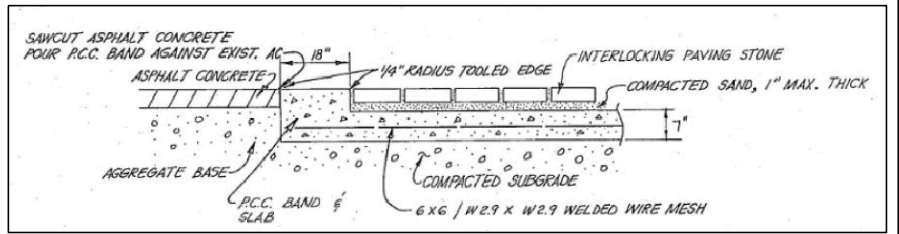
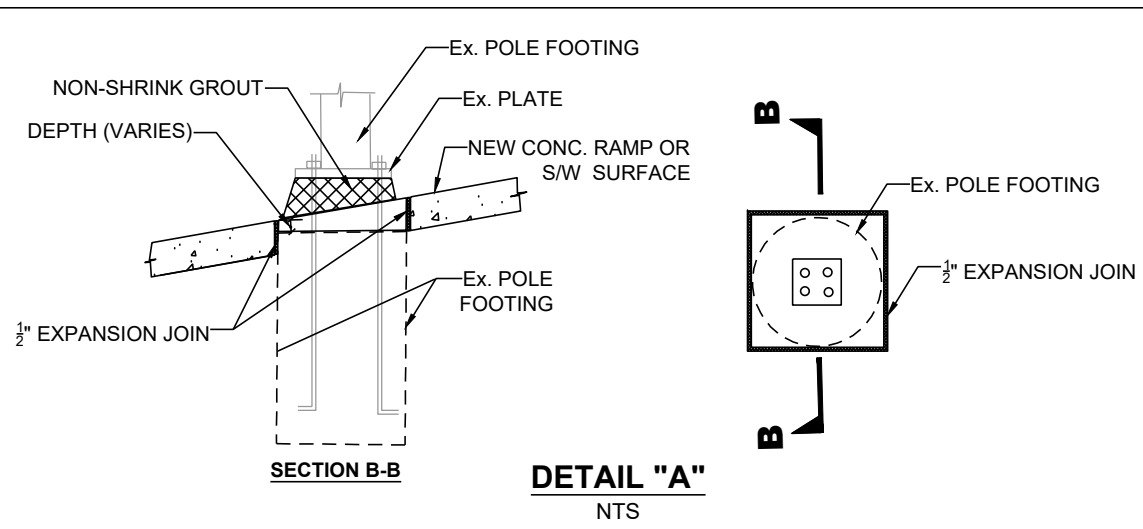
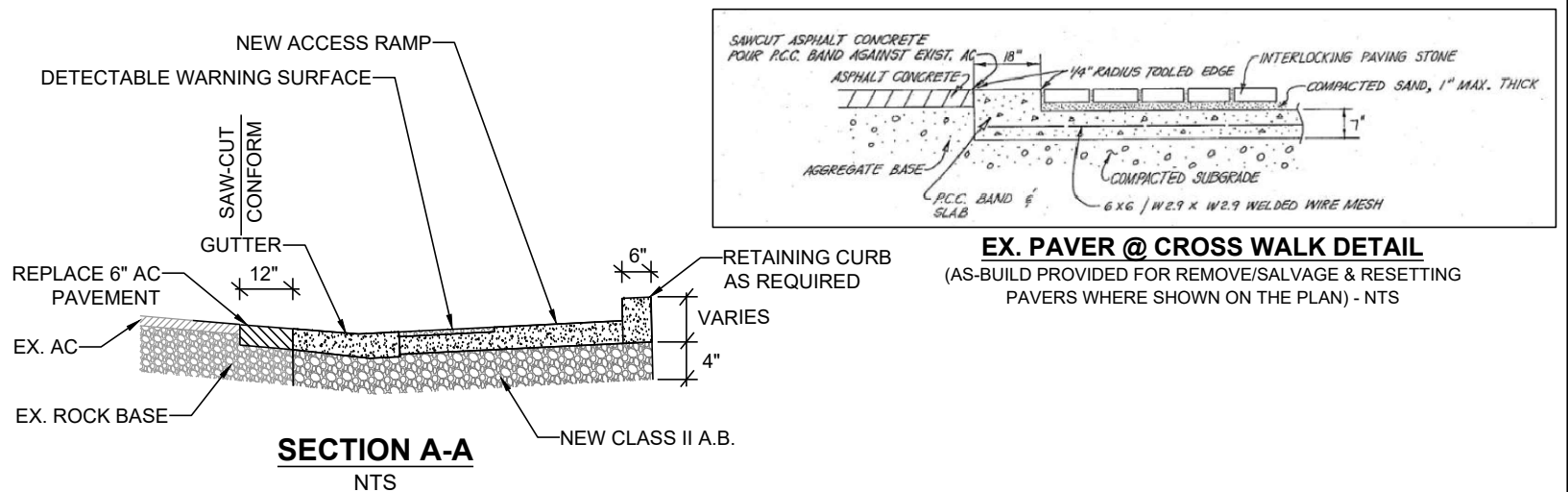
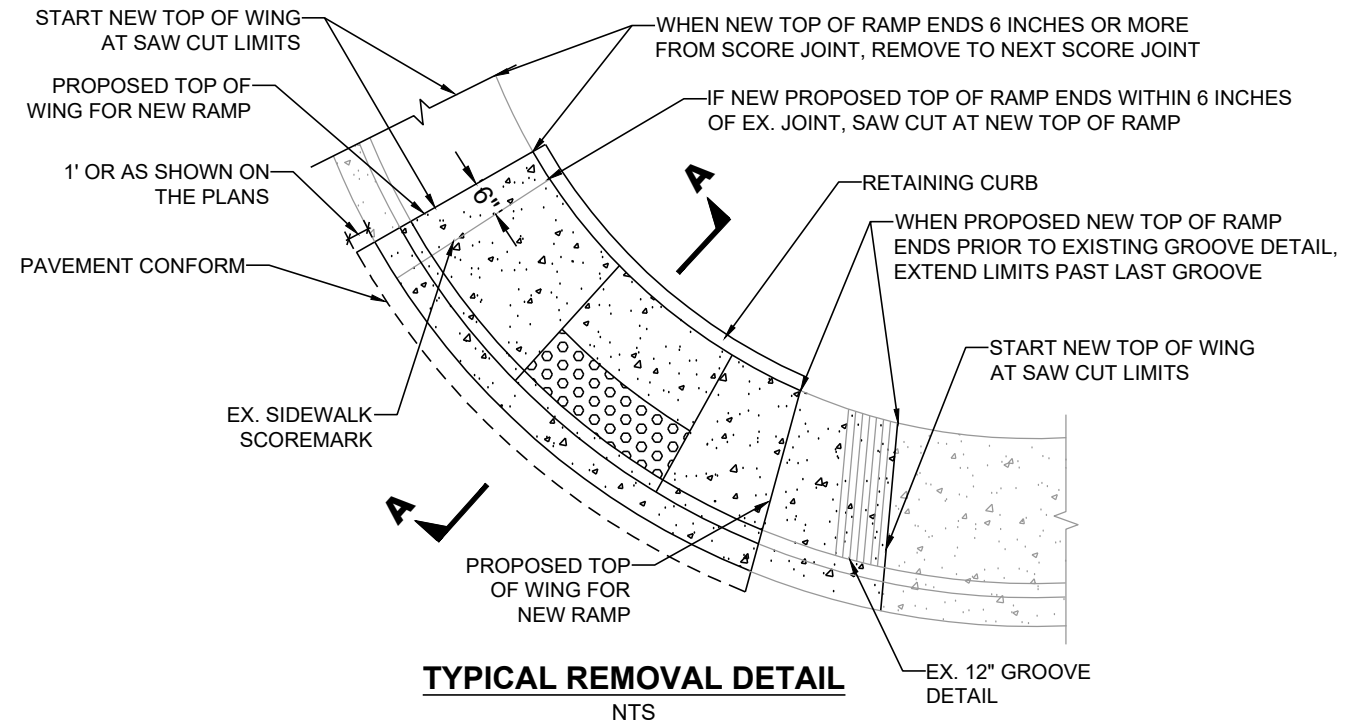

\\delucchi\p\Engineering\Streets\Annual Curb and Gutter Replacement\CP-25509\Design\Drawings\CA\CP-25509_GENERAL.dwg 12-23-24 10:33am snguyen

REV.	DATE	DESCRIPTION		ADAM M. NELKIE CITY ENGINEER NO. 78830 EXP. 9/30/25	ANNUAL CURB AND GUTTER FOR STREET RESURFACING PROJECT GENERAL NOTES AND DETAILS	DESIGN: SN	SCALE: NTS	DWG NO.
						DRAWN: SN	PROJECT NO.: CIP-25509	G-2
						CHECKED: GP	DATE: DEC 23, 2024	2 OF 19
						TRAFFIC ENGINEER: MT		

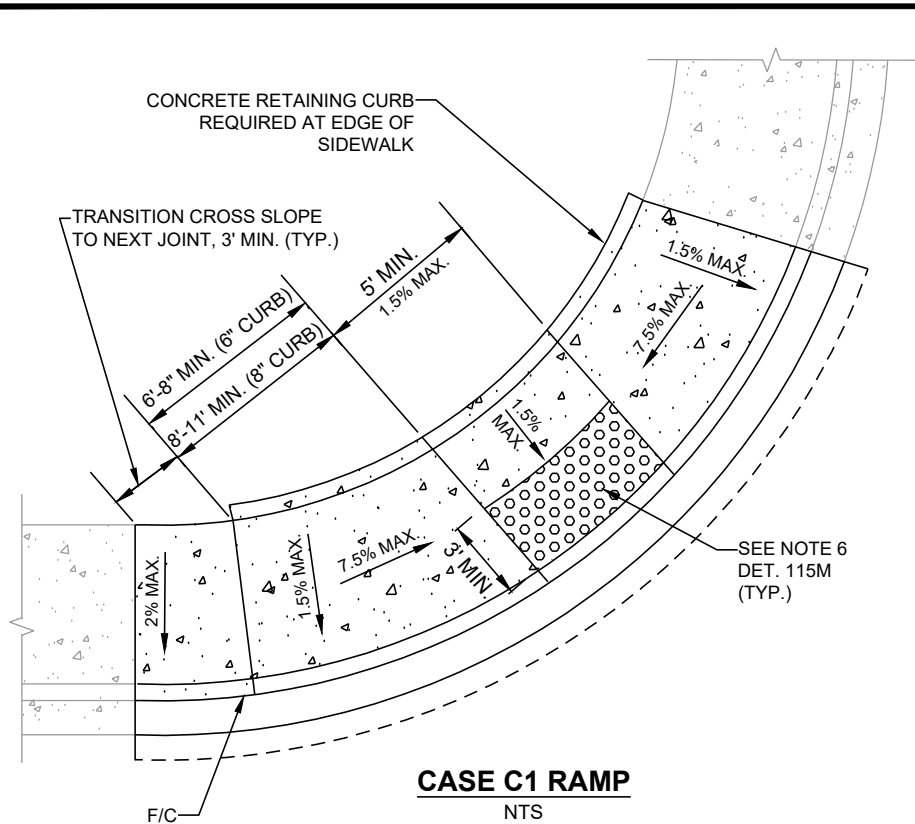

CASE C1 RAMP
NTS

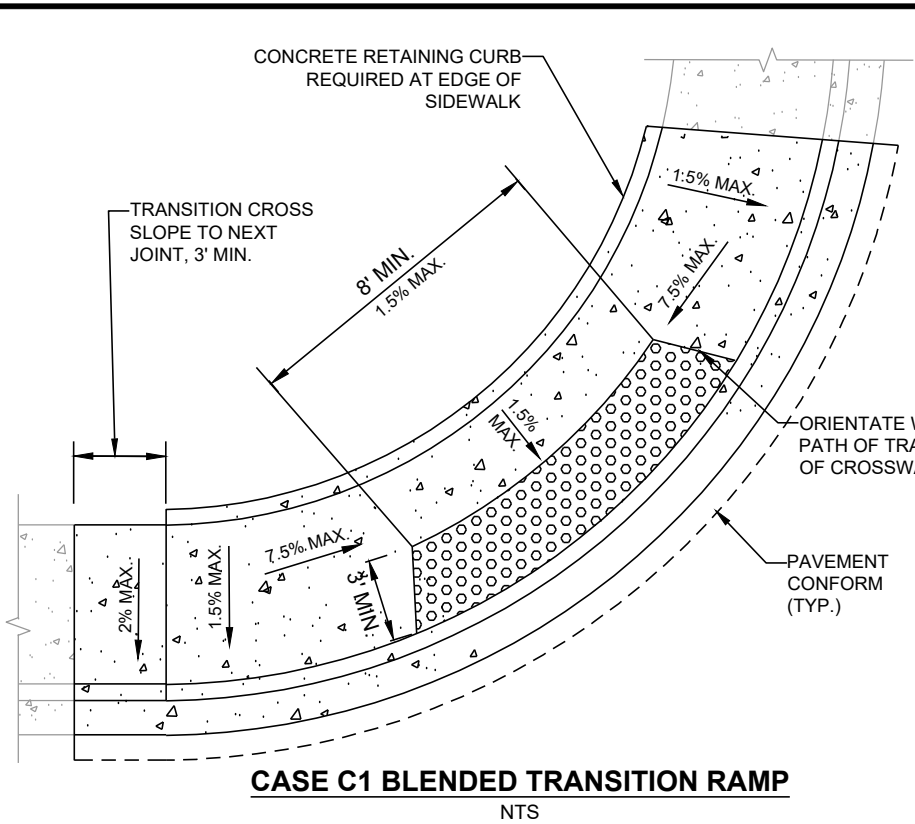

CASE C1 BLENDED TRANSITION RAMP
NTS

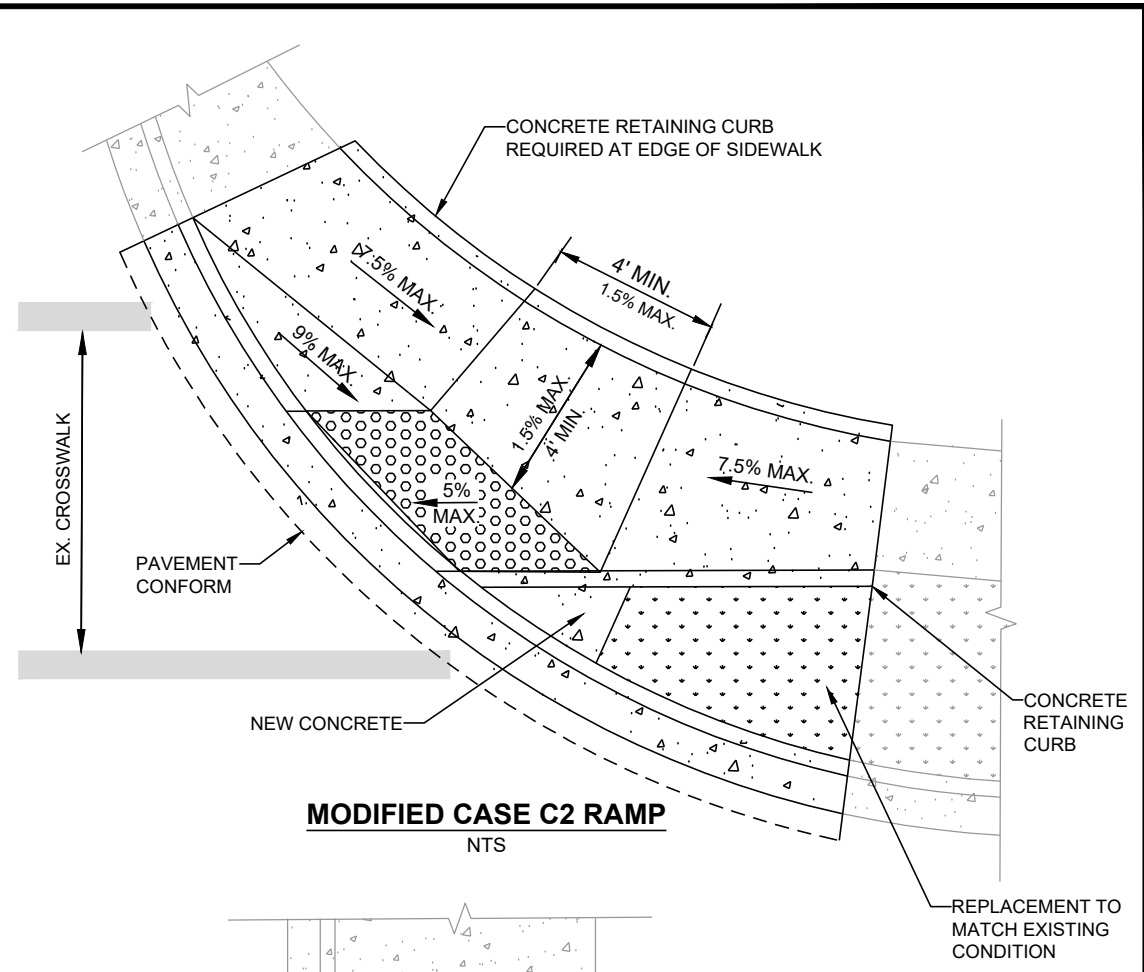

MODIFIED CASE C2 RAMP
NTS

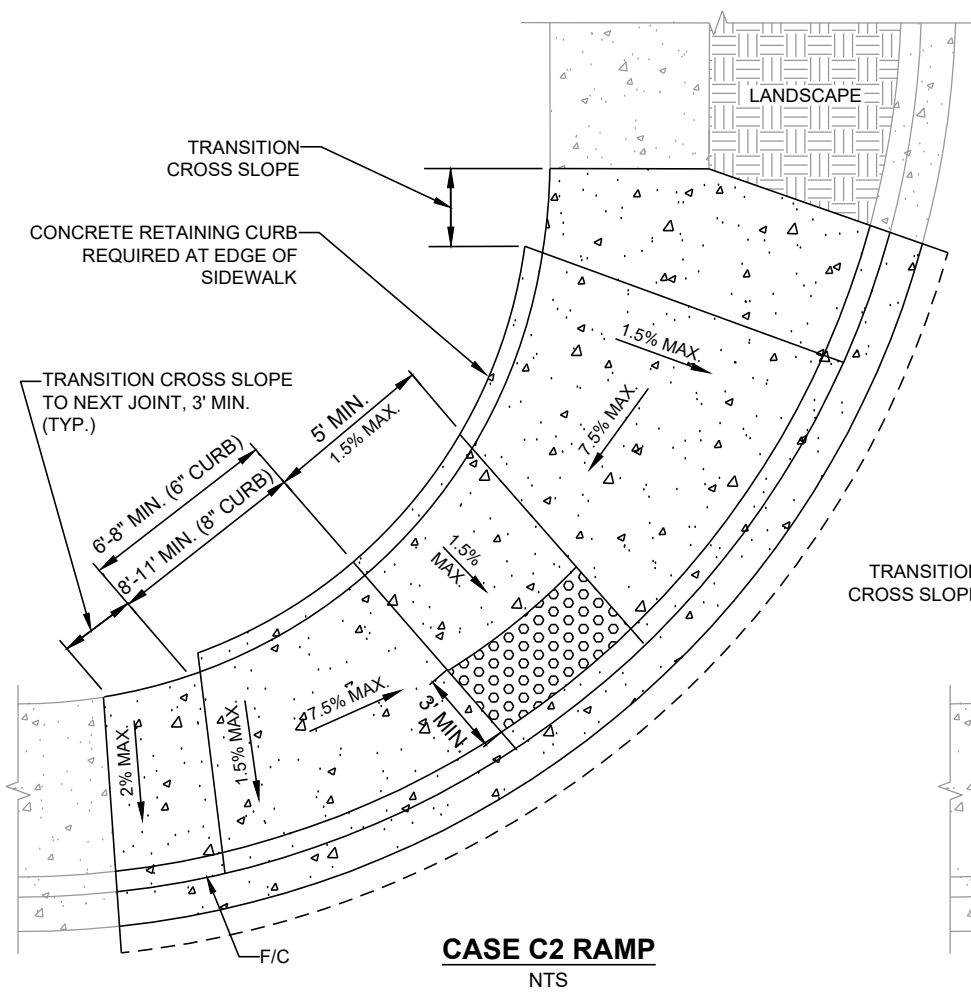

CASE C2 RAMP
NTS

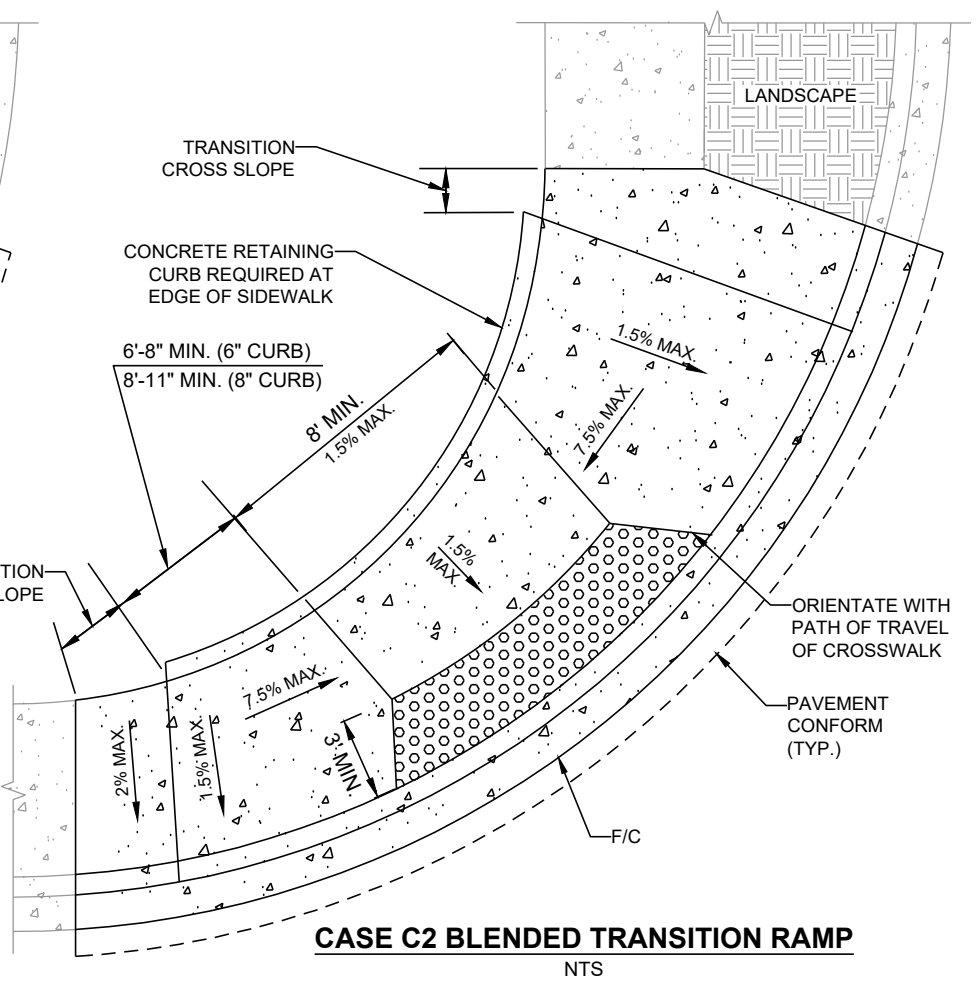

CASE C2 BLENDED TRANSITION RAMP
NTS

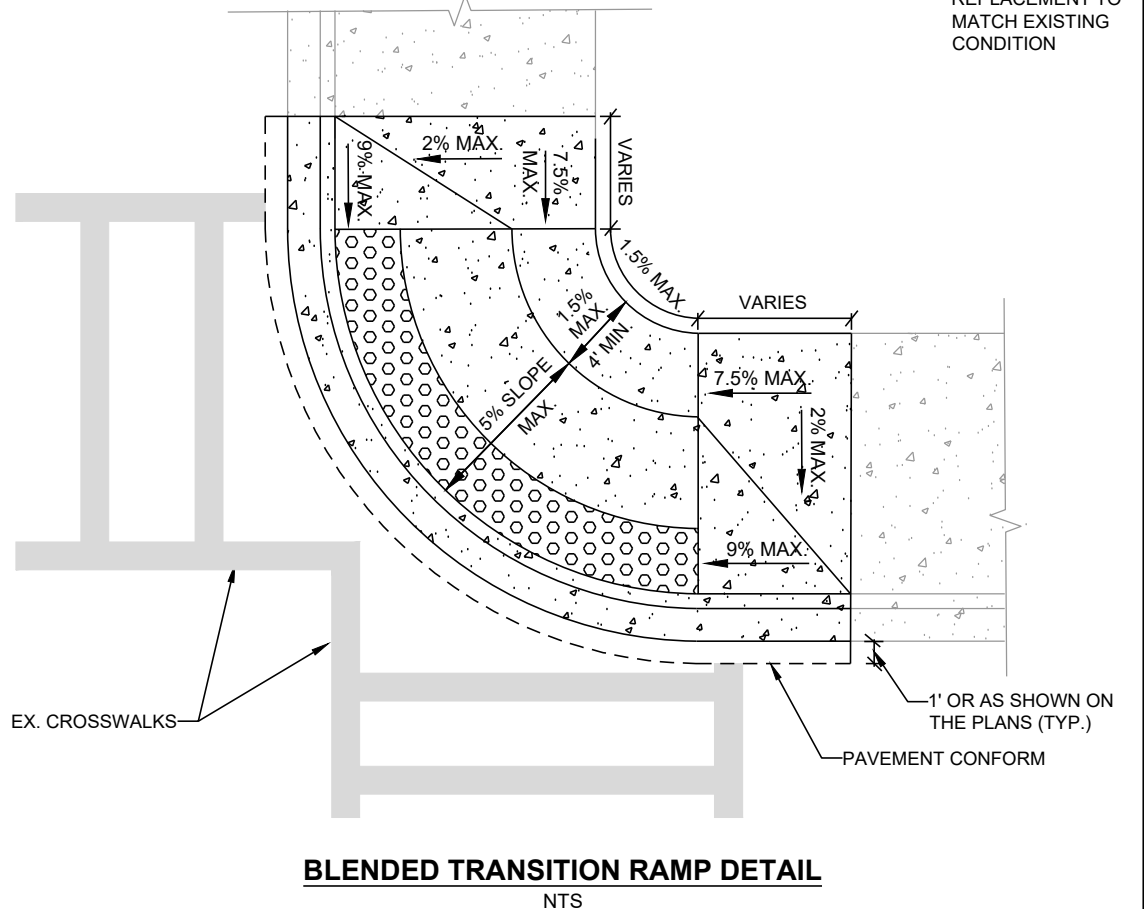

BLENDED TRANSITION RAMP DETAIL
NTS

\\delucchi\p\Engineering\Streets\Annual Curb and Gutter Replacement CIP-25509\Design\Drawings\CA\DCIP-25509_GENERAL.dwg 12-23-24 10:34am snguyen

REV.	DATE	DESCRIPTION	THE CITY OF PLEASANTON		CITY OF PLEASANTON		ANNUAL CURB AND GUTTER FOR STREET RESURFACING PROJECT		DESIGN:	SN	SCALE:	NTS	DWG NO.
			PUBLIC WORKS DEPARTMENT		ADAM M. NELKIE CITY ENGINEER NO. 78830 EXP. 9/30/25		STANDARD RAMP DETAILS		DRAWN:	SN	PROJECT NO.:	CIP-25509	G-3
									CHECKED:	GP	DATE:	DEC 23, 2024	3 OF 19
									TRAFFIC ENGINEER:	MT			

Pollution Prevention - It's Part of the Plan

Make sure your crews and subs do the job right!

Runoff from streets and other paved areas are a major source of pollution in San Francisco Bay. Construction activities can directly affect the health of the Bay unless contractors and crews plan ahead to keep dirt, debris, and other construction waste away from storm drains and local creeks. Following these guidelines will ensure your compliance with the City of Pleasanton requirements. Contact the City of Pleasanton, Department of Engineering at (925) 931-5650, or for private onsite work, please contact the Building and Safety Division at (925) 931-5300.

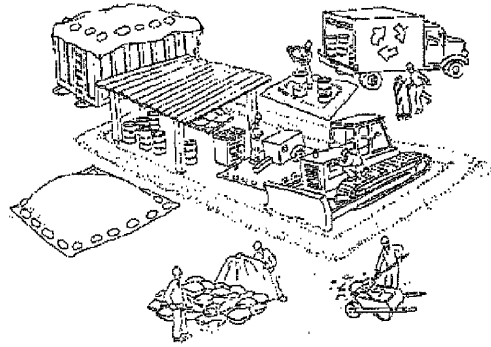

Materials storage & spill cleanup Non-hazardous materials management

- Sand, dirt, and similar materials must be stored at least 10 feet from catch basins, and covered with a tarp during wet weather or when rain is forecast.
- Use (but don't overuse) reclaimed water for dust control as needed.
- Sweep or vacuum streets and other paved areas daily. Do not wash down streets or work areas with water!
- Recycle all asphalt, concrete, and aggregate base material from demolition activities.
- Comply with City Ordinance for recycling construction materials, wood, gyp board, pipe, etc.
- Contact Pleasanton Garbage Service at 925-846-2042 for both recycling and debris disposal.
- Check dumpsters regularly for leaks and to make sure they don't overflow. Repair or replace leaking dumpsters promptly.

Hazardous materials management

- Label all hazardous materials and hazardous wastes (such as pesticides, paints, thinners, solvents, fuel, oil, and antifreeze) in accordance with city, state, and federal regulations.
- Store hazardous materials and wastes in secondary containment and cover them during wet weather.
- Follow manufacturer's application instructions for hazardous materials and be careful not to use more than necessary. Do not apply chemicals outdoors when rain is forecast within 24 hours.
- Be sure to arrange for appropriate disposal of all hazardous wastes.

Spill prevention and control

- Keep a stockpile of spill cleanup materials (rags, absorbents, etc.) available at the construction site at all times.
- When spills or leaks occur, contain them immediately and be particularly careful to prevent leaks and spills from reaching the gutter, street, or storm drain. Never wash spilled material into a gutter, street, storm drain, or creek!
- Report any hazardous materials spills immediately! Dial 911 or the Livermore/Pleasanton Fire Department at 925-454-2330.

Vehicle and equipment maintenance & cleaning

- Inspect vehicles and equipment for leaks frequently. Use drip pans to catch leaks until repairs are made; repair leaks promptly.
- Fuel and maintain vehicles on site only in a bermed area or over a drip pan that is big enough to prevent runoff.
- If you must clean vehicles or equipment on site, clean with water only in a bermed area that will not allow rinse water to run into gutters, streets, storm drains, or creeks.
- Do not clean vehicles or equipment on-site using soaps, solvents, degreasers, steam cleaning equipment, etc.



Earthwork & contaminated soils

- Keep excavated soil on the site where it is least likely to collect in the street. Transfer to dump trucks should take place on the site, not in the street.
- Use fiber rolls, silt fences, or other control measures to minimize the flow of silt off the site. See the approved erosion control plan for this site.



- Earth moving activities are only allowed during dry weather by permit and as approved by the City Inspector in the Field.
- Mature vegetation is the best form of erosion control. Minimize disturbance to existing vegetation whenever possible.
- If you disturb a slope during construction, prevent erosion by securing the soil with erosion control fabric, or seed with fast-growing grasses as soon as possible. Place fiber rolls down-slope until soil is secure.

➤ If you suspect contamination (from site history, discoloration, odor, texture, abandoned underground tanks or pipes, or buried debris), call Pleasanton/Livermore Fire Department at 925-454-2330 or the Regional Water Quality Control Board for help in determining what should be done, and manage disposal of contaminated soil according to their instructions.

Dewatering operations

- Reuse water for dust control, irrigation, or another on-site purpose to the greatest extent possible.
- Be sure to call Pleasanton's storm drain source control inspector, Brian Lorimer, before discharging water to a street, gutter, or storm drain (925-931-5511). Filtration or diversion through a basin, tank, or sediment trap may be required.
- In areas of known contamination, testing is required prior to reuse or discharge of groundwater. Consult with the city inspector to determine what testing is required and how to interpret results. Contaminated groundwater must be treated or hauled off-site for proper disposal.

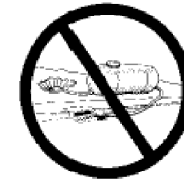

Saw cutting

- Always completely cover or barricade storm drain inlets when saw cutting. Use filter fabric, catch basin inlet filters, or sand/gravel bags to keep slurry out of the storm drain system.
- Shovel, absorb, or vacuum saw-cut slurry and pick up all waste as soon as you are finished in one location or at the end of each work day (whichever is sooner!).
- If saw cut slurry enters a catch basin, clean it up immediately.



Paving/asphalt work

- Do not pave during wet weather or when rain is forecast.
- Always cover storm drain inlets and manholes when paving or applying seal coat, tack coat, slurry seal, or fog seal.
- Place drip pans or absorbent material under paving equipment when not in use.
- Protect gutters, ditches, and drainage courses with sand/gravel bags, or earthen berms.
- Do not sweep or wash down excess sand from sand sealing into gutters, storm drains, or creeks. Collect sand and return it to the stockpile, or dispose of it as trash.
- Do not use water to wash down fresh asphalt concrete pavement.

Concrete, grout, and mortar storage & waste disposal

- Be sure to store concrete, grout, and mortar under cover and away from drainage areas. These materials must never reach a storm drain.
- Wash out concrete equipment/trucks off-site or designate an on-site area for washing where water will flow onto dirt or into a temporary pit in a dirt area. Let the water seep into the soil and dispose of hardened concrete with trash.
- Divert water from washing exposed aggregate concrete to a dirt area where it will not run into a gutter, street, or storm drain.
- If a suitable dirt area is not available, collect the wash water and remove it for appropriate disposal off site.



Painting

- Never rinse paint brushes or materials in a gutter or street!
- Paint out excess water-based paint before rinsing brushes, rollers, or containers in a sink. If you can't use a sink, direct wash water to a dirt area and spade it in.
- Paint out excess oil-based paint before cleaning brushes in thinner.
- Filter paint thinners and solvents for reuse whenever possible. Dispose of oil-based paint sludge and unusable thinner as hazardous waste.



Storm drain polluters maybe liable for fines of \$10,000 or more per day!

Bay Area Stormwater Management Agencies Association (BASMAA)
1-888-BAYWISE

For more detailed information:
Get a copy of the "Field Manual" -- (510) 622-2465 or
www.abag.ca.gov/bayarea/sfep/reports/construction.html

REV.	DATE	DESCRIPTION	THE CITY OF PLEASANTON			ADAM M. NELKIE CITY ENGINEER NO. 78830 EXP. 9/30/25	ANNUAL CURB AND GUTTER FOR STREET RESURFACING PROJECT	DESIGN: SN	SCALE: NTS	DWG NO.
			CITY OF PLEASANTON PUBLIC WORKS DEPARTMENT				POLLUTION PREVENTION PLAN	DRAWN: SN	PROJECT NO.: CIP-25509	G-4
								CHECKED: GP	DATE: DEC 23, 2024	4 OF 19
								TRAFFIC ENGINEER: MT		

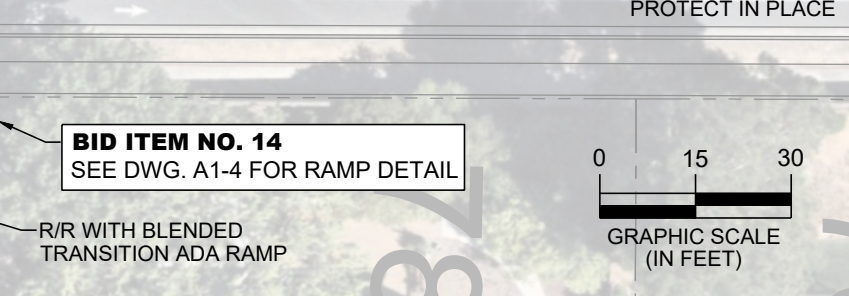
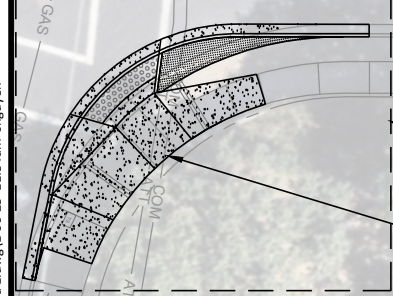
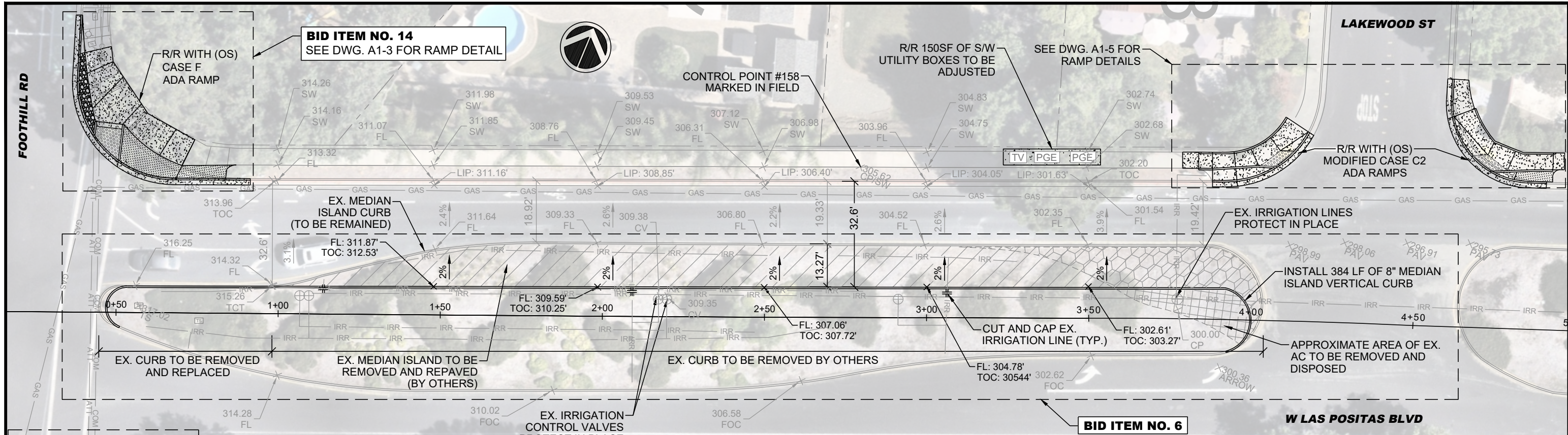

LEGEND

- EX. MEDIAN ISLAND TO BE REMOVED AND REPAVED BY OTHERS
- EX. AC TO BE REMOVED AND DISPOSED
- EX. AC TO BE REMOVED AND DISPOSED BY OTHERS
- EX. IRRIGATION LINE TO BE CUT AND CAP (APPROXIMATELY 3 TOTAL)
- EX. IRRIGATION VALVES

- NOTES:**
- BID ITEM NO. 6 SHALL INCLUDE ALL WORK ASSOCIATED WITH THE MEDIAN ISLAND AS SHOWN ON THIS DRAWING
 - CONTRACTOR SHALL LOCATE ALL EXISTING IRRIGATION LINES WITHIN THE MEDIAN ISLAND.
 - CONTRACTOR SHALL ADJUST EX. SPRAY HEADS BEHIND NEW MEDIAN CURB TO 180 DEGREE.

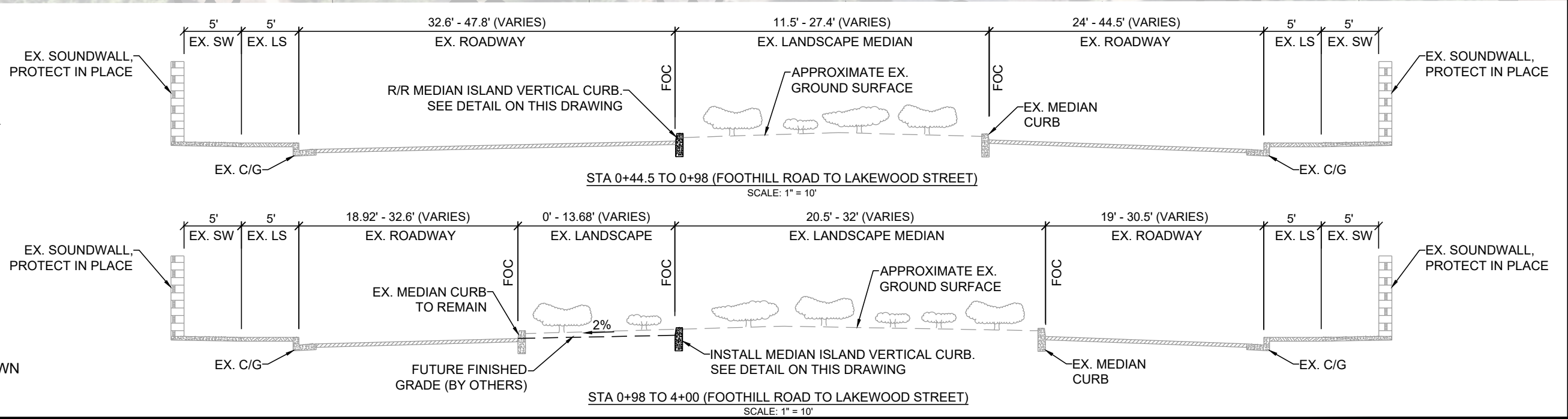
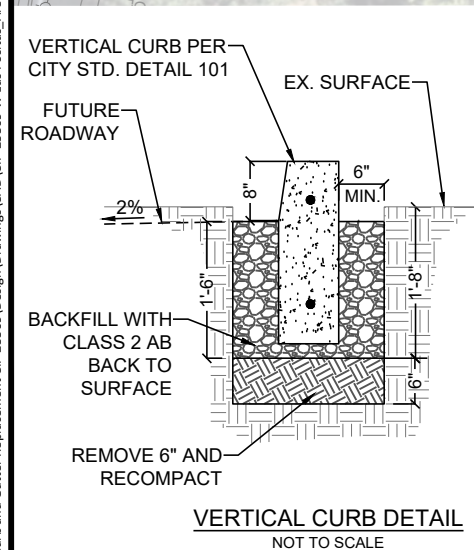

NOTE:
1. EXISTING GROUND SURFACE SHOWN ON THE PLAN IS APPROXIMATE. DEPTH VARIES.

\\delucchi\p\Engineering\Streets\Annual Curb and Gutter Replacement\Drawings\CA\CP-25509\W Las Positas - Area 1.dwg 1-06-25 09:06am snguyen

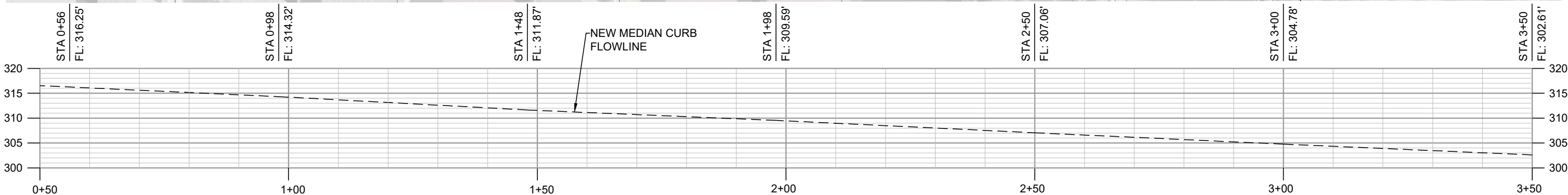
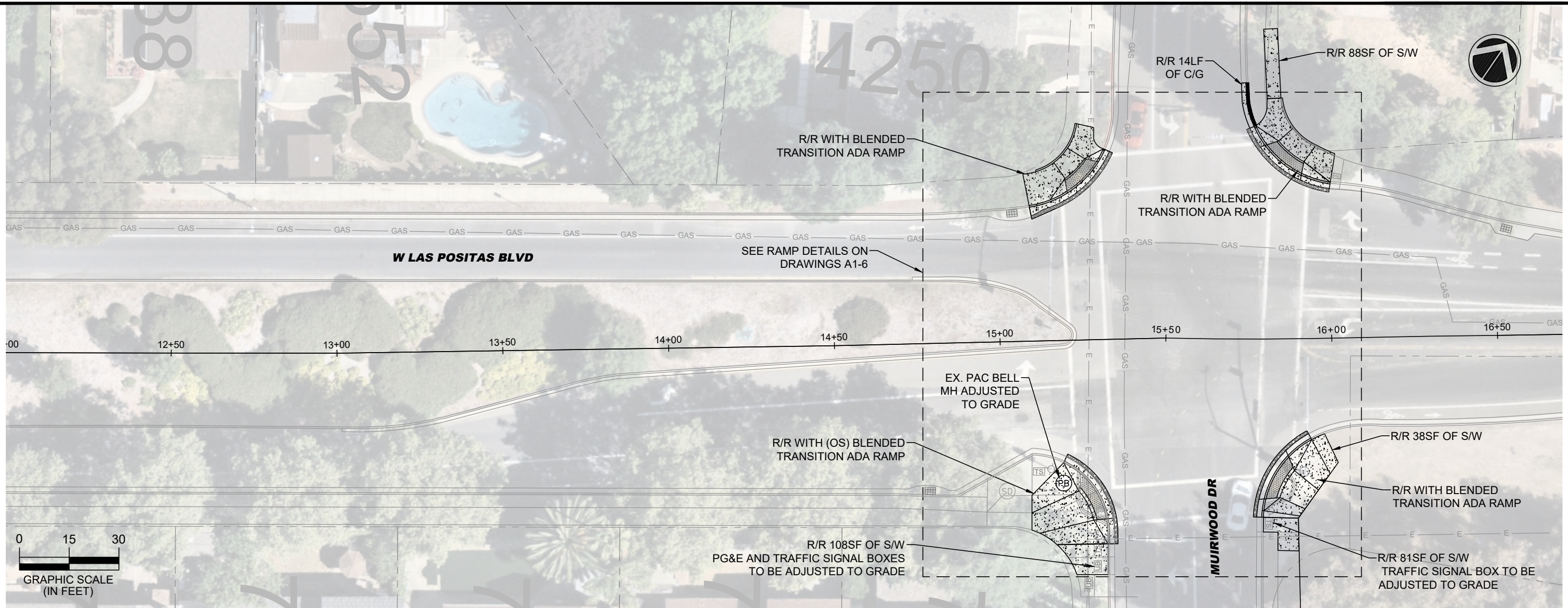

STA 0+50 TO STA 3+50 (FOOTHILL ROAD TO LAKEWOOD STREET)
SCALE: 1" = 20'

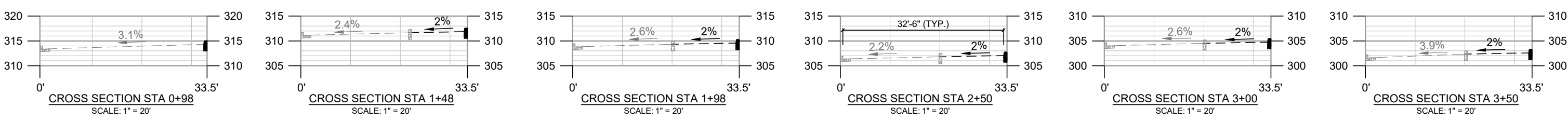

REV.	DATE	DESCRIPTION

THE CITY OF PLEASANTON
PUBLIC WORKS DEPARTMENT

ADAM M. NELKIE
CITY ENGINEER
NO. 78830
EXP. 9/30/25

ANNUAL CURB AND GUTTER FOR STREET RESURFACING PROJECT
WEST LAS POSITAS BOULEVARD STA 12+00 TO STA 16+69

DESIGN:	SN	SCALE:	AS SHOWN	DWG NO.
DRAWN:	SN	PROJECT NO.:	CIP-25509	A1-2
CHECKED:	GP	DATE:	DEC 23, 2024	6 OF 19
TRAFFIC ENGINEER:	MT			



(7988)

FOOTHILL RD.

W. LAS POSITAS BLVD.

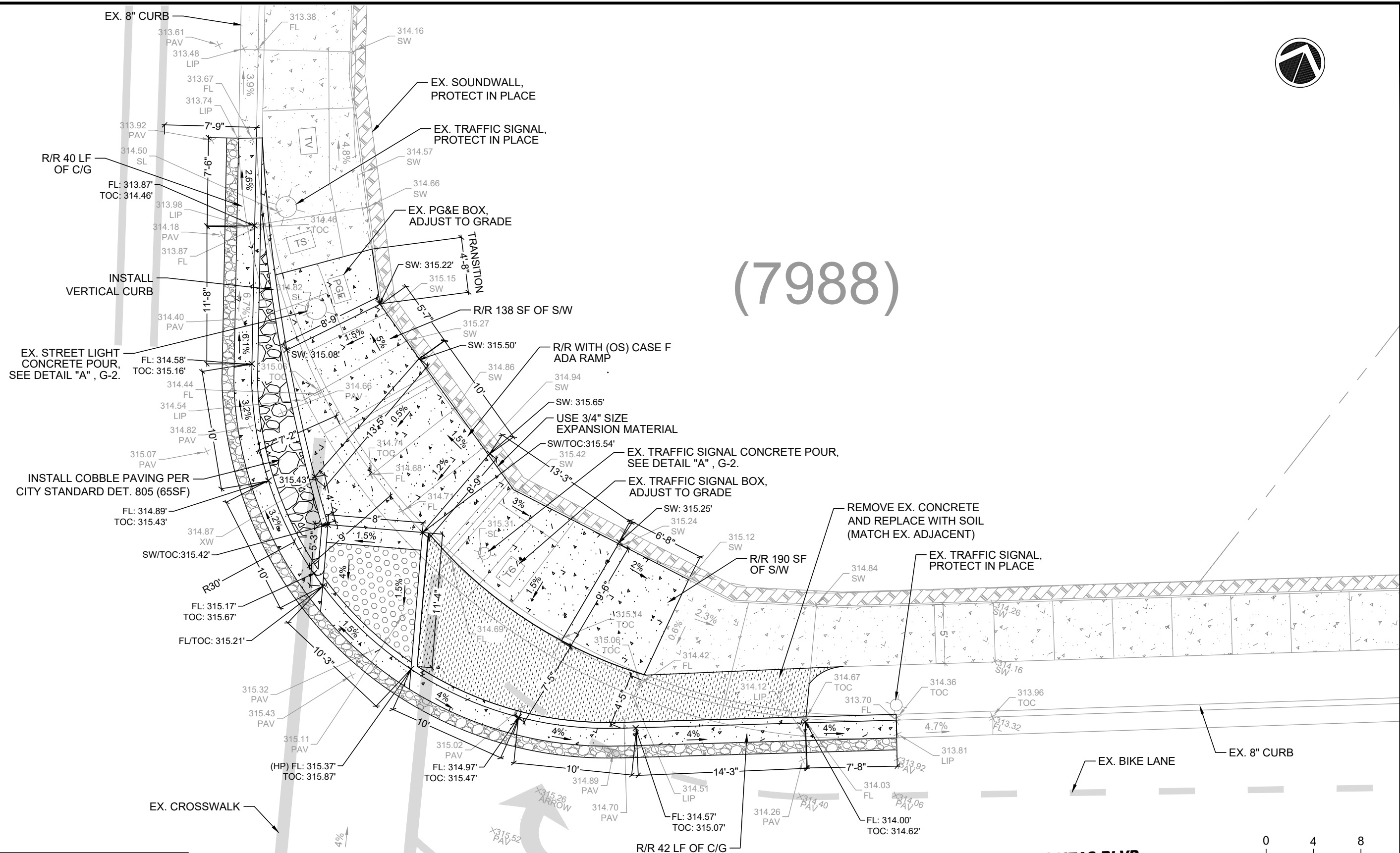

EX. STREET LIGHT CONCRETE POUR, SEE DETAIL "A", G-2.

INSTALL COBBLE PAVING PER CITY STANDARD DET. 805 (65SF)

EX. SOUNDWALL, PROTECT IN PLACE

EX. TRAFFIC SIGNAL, PROTECT IN PLACE

EX. PG&E BOX, ADJUST TO GRADE

R/R WITH (OS) CASE F ADA RAMP

USE 3/4" SIZE EXPANSION MATERIAL

EX. TRAFFIC SIGNAL CONCRETE POUR, SEE DETAIL "A", G-2.

EX. TRAFFIC SIGNAL BOX, ADJUST TO GRADE

REMOVE EX. CONCRETE AND REPLACE WITH SOIL (MATCH EX. ADJACENT)

EX. TRAFFIC SIGNAL, PROTECT IN PLACE

EX. BIKE LANE

EX. 8" CURB

BID ITEM NO. 14 SHALL INCLUDE ALL WORK INDICATED ON THIS DRAWING.

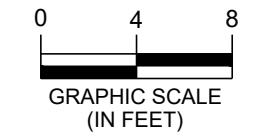

\\delucchi\p\Engineering\Streets\Annual Curb and Gutter Replacement CIP-25509\Drawings\CA\DCIP-25509 W Las Positas and Foothill Ramp Details A1-3 and A1-4.dwg 12-23-24 12:04pm snguyen

REV.	DATE	DESCRIPTION	THE CITY OF PLEASANTON		CITY OF PLEASANTON PUBLIC WORKS DEPARTMENT		ANNUAL CURB AND GUTTER FOR STREET RESURFACING PROJECT		DESIGN:	SN	SCALE:	AS SHOWN	DWG NO.
			PLEASANTON		ADAM M. NELKIE CITY ENGINEER NO. 78830 EXP. 9/30/25		WEST LAS POSITAS BOULEVARD AND FOOTHILL ROAD NORTH RAMP DETAIL		DRAWN:	SN	PROJECT NO.:	CIP-25509	A1-3
									CHECKED:	GP	DATE:	DEC 23, 2024	7 OF 19
									TRAFFIC ENGINEER:	MT			



FOOTHILL RD.

W. LAS POSITAS BLVD.

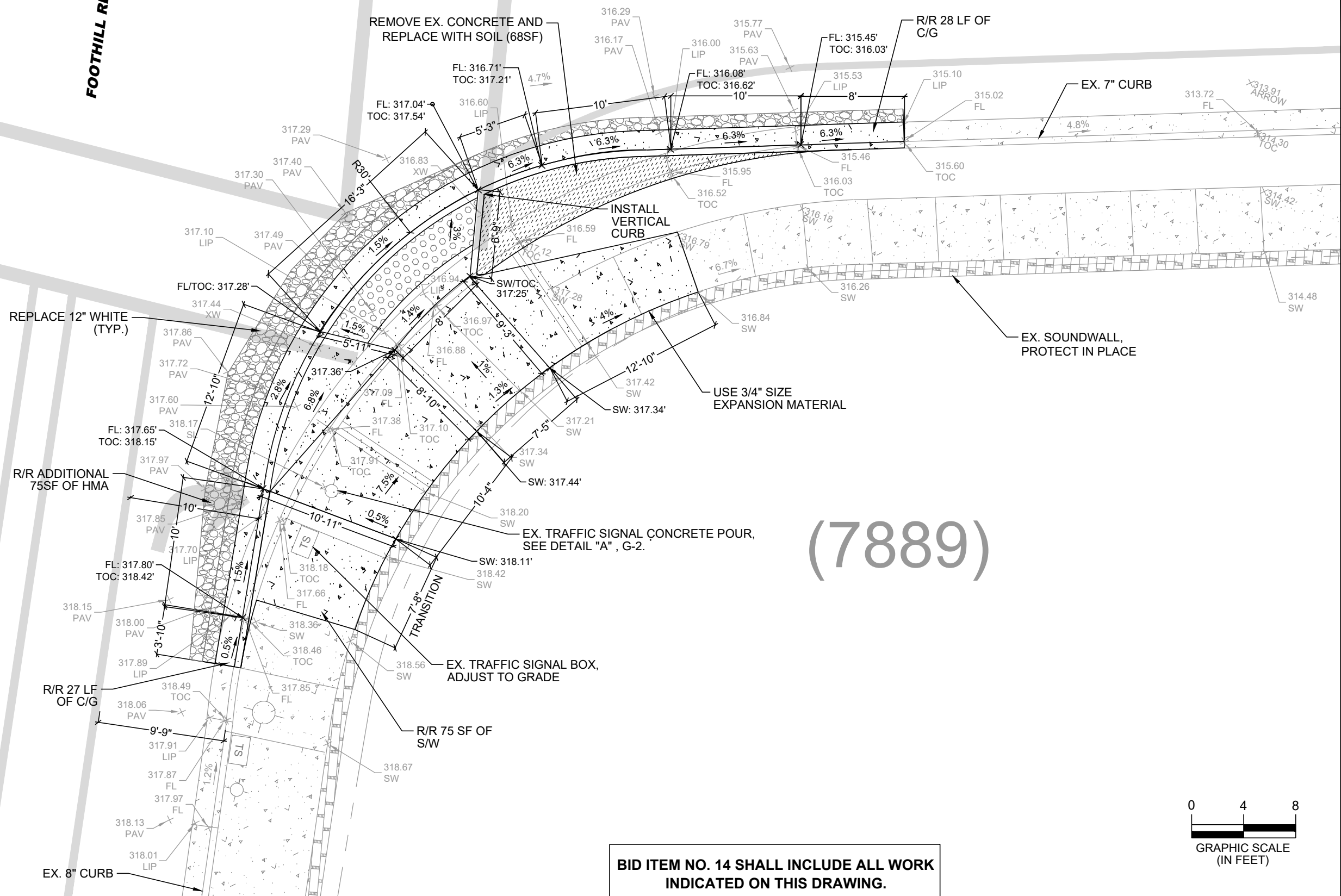

(7889)

BID ITEM NO. 14 SHALL INCLUDE ALL WORK INDICATED ON THIS DRAWING.

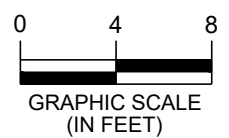

\\delucchi\p\Engineering\Streets\Annual Curb and Gutter Replacement\Drawings\CAD\Archive\CIP-25509 W Las Positas and Foothill Ramp Details A1-3 and A1-4 - V2.dwg(12-23-24 02:34pm snguyen

REV.	DATE	DESCRIPTION



CITY OF PLEASANTON
PUBLIC WORKS DEPARTMENT

ADAM M. NELKIE
CITY ENGINEER
NO. 78830
EXP. 9/30/25

ANNUAL CURB AND GUTTER FOR STREET RESURFACING PROJECT
WEST LAS POSITAS BOULEVARD AND FOOTHILL ROAD SOUTH RAMP DETAIL

DESIGN: SN
DRAWN: SN
CHECKED: GP
TRAFFIC ENGINEER: MT

SCALE: AS SHOWN
PROJECT NO.: CIP-25509
DATE: DEC 23, 2024

DWG NO. **A1-4**
8 OF 19



(7918)

(7854)

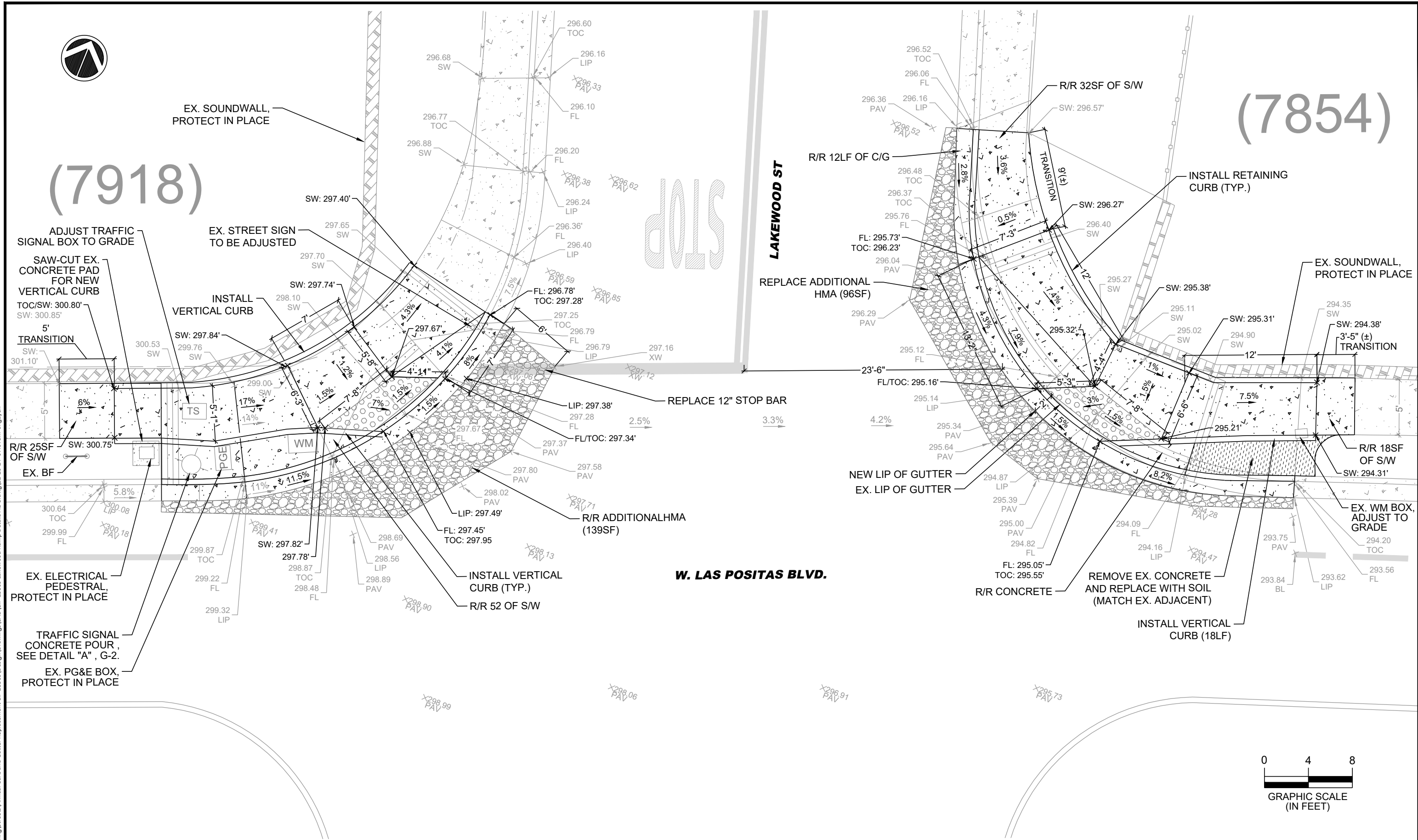

\\delucchi\p\Engineering\Streets\Annual Curb and Gutter Replacement CIP-25509\Drawings\CA\Drawings\A1-5.dwg 12-26-24 07:07am snguyen

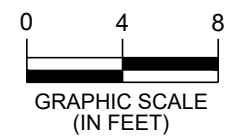

REV.	DATE	DESCRIPTION	THE CITY OF PLEASANTON		CITY ENGINEER		ANNUAL CURB AND GUTTER FOR STREET RESURFACING PROJECT		DESIGN:	SN	SCALE:	AS SHOWN	DWG NO.
			CITY OF PLEASANTON		ADAM M. NELKIE		WEST LAS POSITAS BOULEVARD AND LAKEWOOD STREET RAMP DETAILS		DRAWN:	SN	PROJECT NO.:	CIP-25509	A1-5
			PUBLIC WORKS DEPARTMENT		NO. 78830				CHECKED:	GP	DATE:	DEC 23, 2024	9 OF 19
					EXP. 9/30/25				TRAFFIC ENGINEER:	MT			

(4250)

(7201)

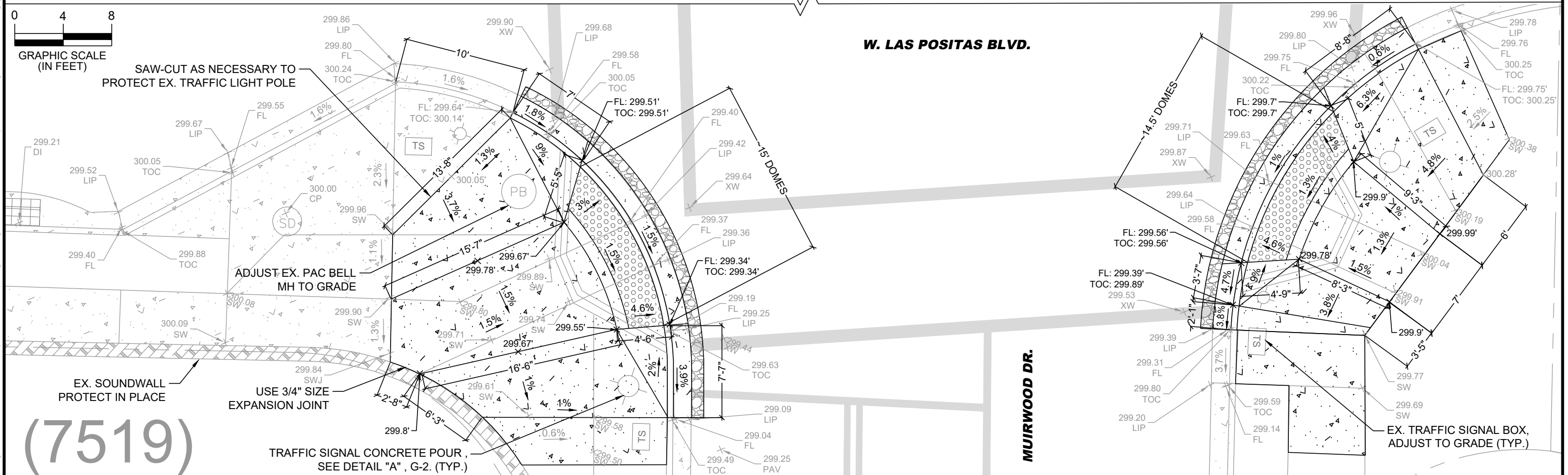
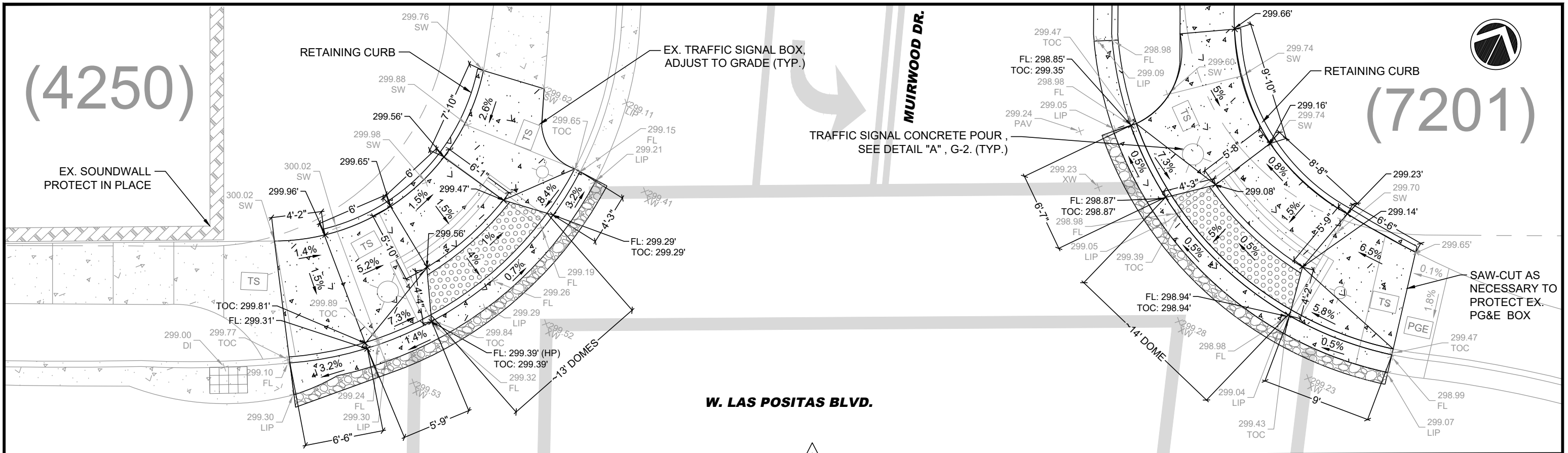

REV.	DATE	DESCRIPTION

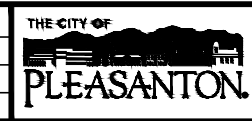

CITY OF PLEASANTON
PUBLIC WORKS DEPARTMENT

ADAM M. NELKIE
CITY ENGINEER
NO. 78830
EXP. 9/30/25

ANNUAL CURB AND GUTTER FOR STREET RESURFACING PROJECT
WEST LAS POSITAS BOULEVARD AND MUIRWOOD DRIVE RAMP DETAILS

DESIGN:	SN	SCALE:	AS SHOWN	DWG NO.
DRAWN:	SN	PROJECT NO.:	CIP-25509	A1-6
CHECKED:	GP	DATE:	DEC 23, 2024	10 OF 19
TRAFFIC ENGINEER:	MT			

\\delucchi\p\Engineering\Streets\Annual Curb and Gutter Replacement\CIP-25509\Drawings\CA\CP-25509 Muirwood Ramp details A1-6.dwg 11:14am snguyen



PLEASANTON TENNIS AND COMMUNITY PARK

PASEO SANTA CRUZ

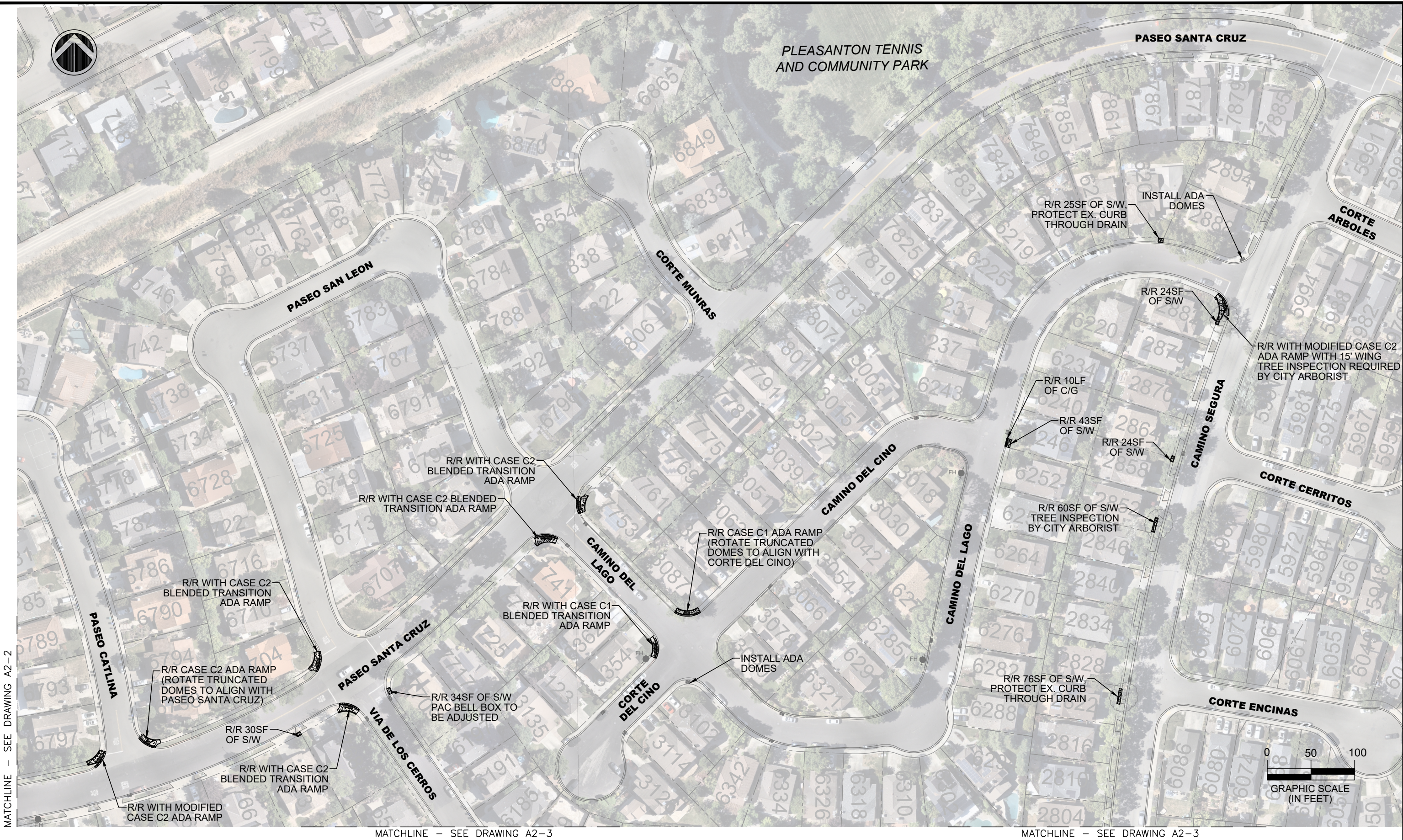

MATCHLINE - SEE DRAWING A2-2

MATCHLINE - SEE DRAWING A2-3

MATCHLINE - SEE DRAWING A2-3

REV.	DATE	DESCRIPTION

THE CITY OF PLEASANTON
CITY OF PLEASANTON
PUBLIC WORKS DEPARTMENT

ADAM M. NELKIE
 CITY ENGINEER
 NO. 78830
 EXP. 9/30/25

ANNUAL CURB AND GUTTER FOR STREET RESURFACING PROJECT
 CAMINO DEL LAGO, CAMINO SEGURA, CAMINO DEL CINO, COURTE DEL CINO, PASEO SANTA CRUZ AND VIA DE LOS CERROS

DESIGN:	SN	SCALE:	AS SHOWN	DWG NO.
DRAWN:	SN	PROJECT NO.:	CIP-25509	A2-1
CHECKED:	GP	DATE:	DEC 23, 2024	11 OF 19
TRAFFIC ENGINEER:	MT			

\\delucchi\p\engineering\Streets\Annual Curb and Gutter Replacement CIP 25509\Design\Drawings\CAD\CIP-25509_Paseo and Valley Area 2.dwg(12:23:24 12:36pm snguyen)

\\delucchi\p\Engineering\Streets\Annual Curb and Gutter Replacement CIP-25509\Drawings\CA\CP-25509_Paseo and Valley Area 2.dwg 12-23-24 12:38pm snguyen

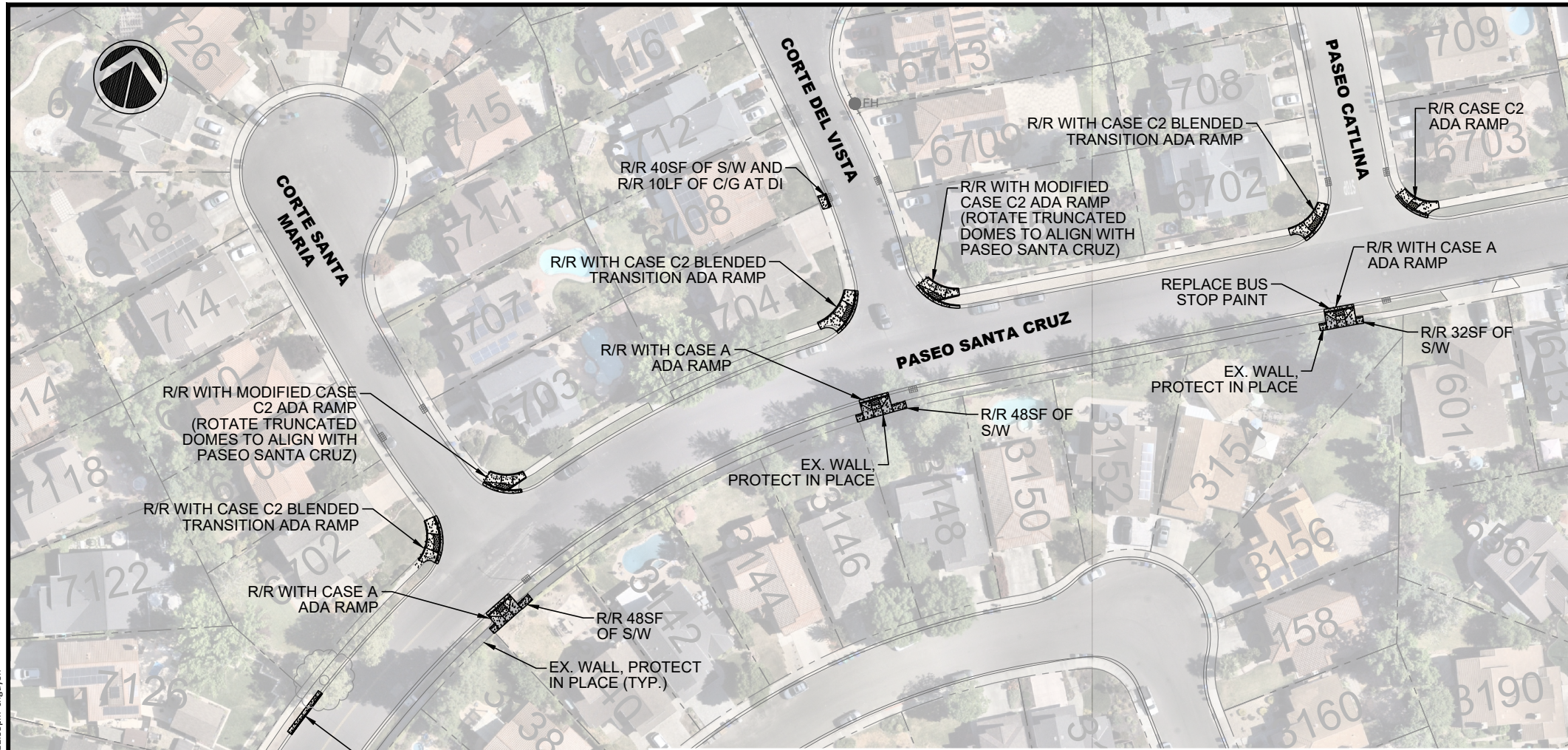

MATCHLINE - SEE DRAWING A2-1

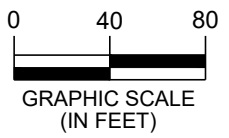
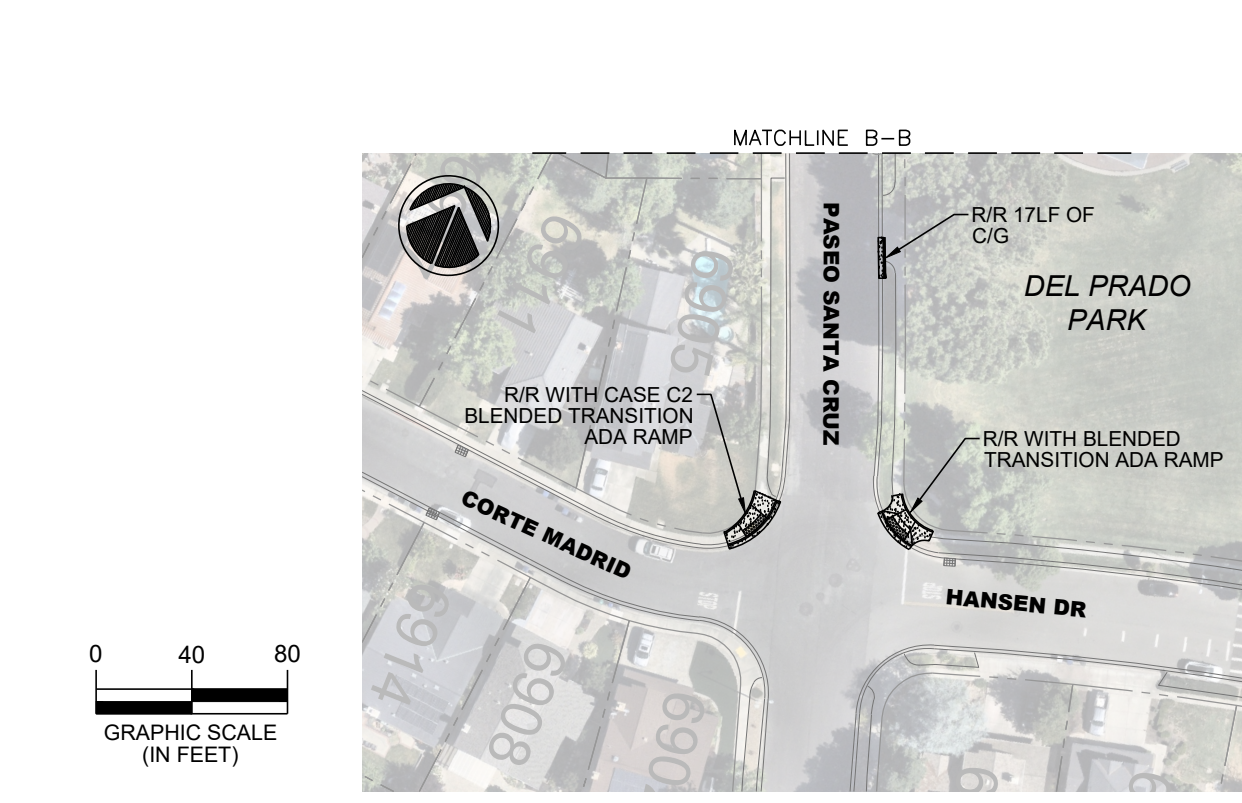
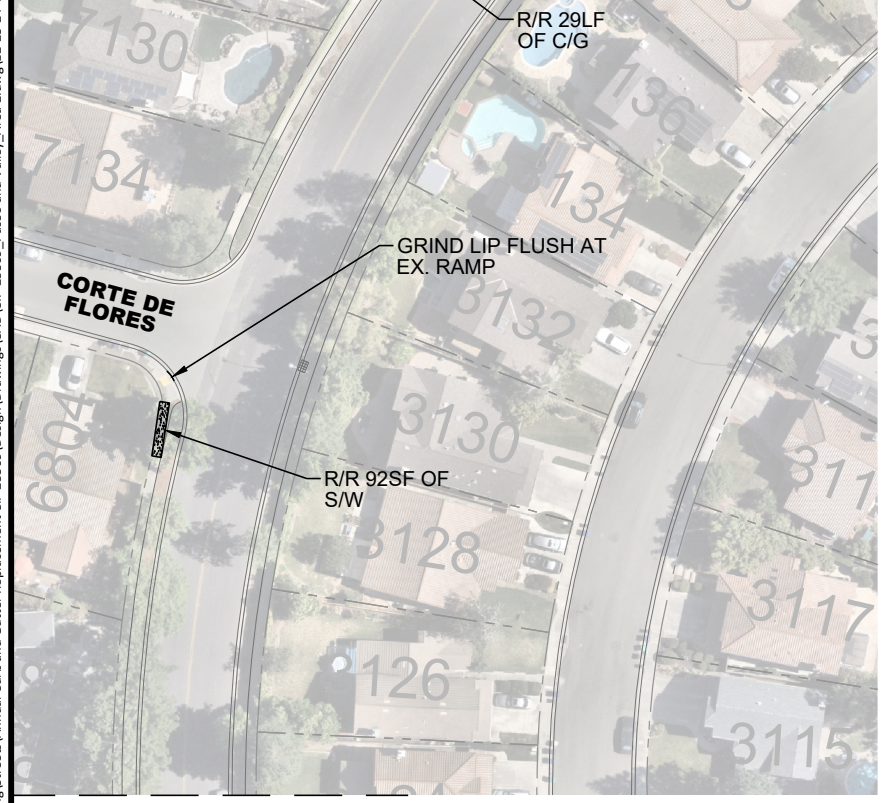
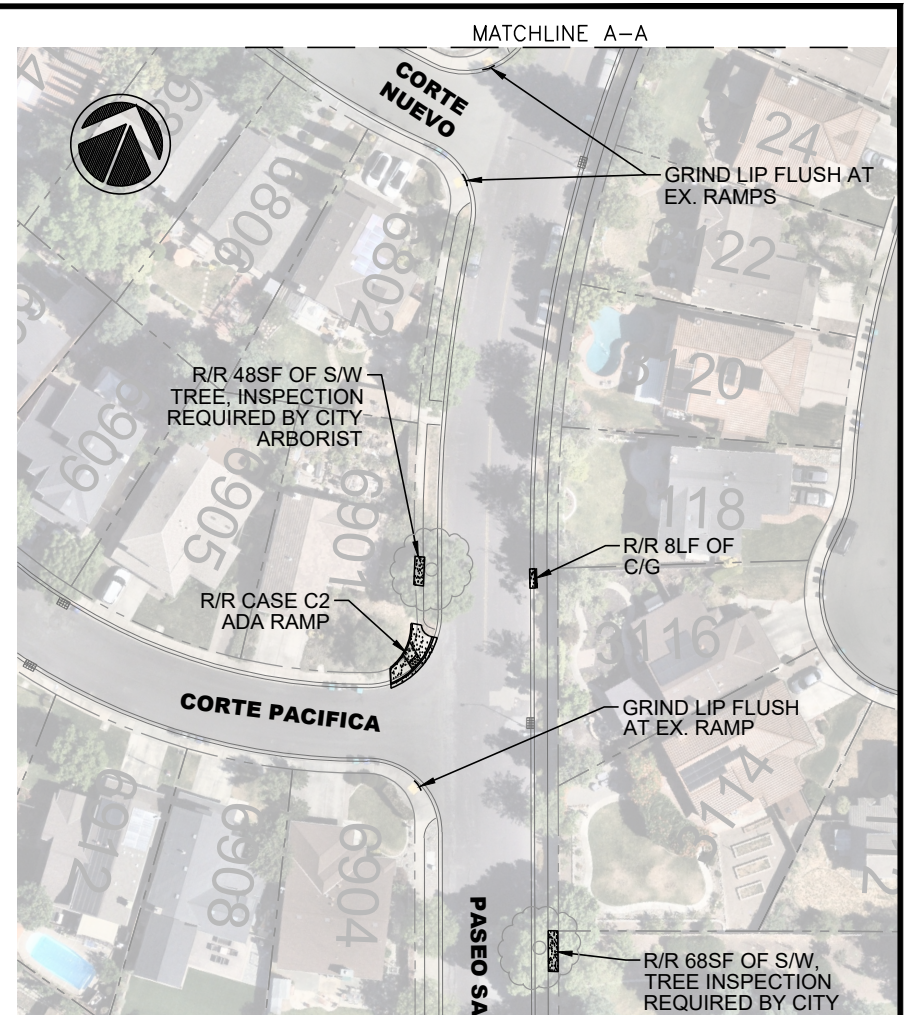

MATCHLINE A-A

MATCHLINE B-B

REV.	DATE	DESCRIPTION

CITY OF PLEASANTON
 PUBLIC WORKS DEPARTMENT

ADAM M. NELKIE
 CITY ENGINEER
 NO. 78830
 EXP. 9/30/25

ANNUAL CURB AND GUTTER FOR STREET RESURFACING PROJECT
PASEO SANTA CRUZ AND CORTE DEL VISTA

DESIGN:	SN	SCALE:	AS SHOWN	DWG NO.
DRAWN:	SN	PROJECT NO.:	CIP-25509	A2-2
CHECKED:	GP	DATE:	DEC 23, 2024	12 OF 19
TRAFFIC ENGINEER:	MT			

MATCHLINE - SEE DRAWING A2-1

MATCHLINE - SEE DRAWING A2-1



MATCHLINE - SEE DRAWING A2-4

\\delucchi\p\Engineering\Streets\Annual Curb and Gutter Replacement\CP 25509\Design\Drawings\CA\CP-25509_Paseo and Valley Area 2.dwg(12-23-24 12:34pm snguyen

REV.	DATE	DESCRIPTION



CITY OF PLEASANTON
PUBLIC WORKS DEPARTMENT

ADAM M. NELKIE
CITY ENGINEER
NO. 78830
EXP. 9/30/25

ANNUAL CURB AND GUTTER FOR STREET RESURFACING PROJECT
CAMINO SEGURA, CALLE DE LA LOMA AND VIA DE LOS CERROS

DESIGN: SN
DRAWN: SN
CHECKED: GP
TRAFFIC ENGINEER: MT

SCALE: AS SHOWN
PROJECT NO.: CIP-25509
DATE: DEC 23, 2024

DWG NO. **A2-3**
13 OF 19

MATCHLINE - SEE DRAWING A2-3

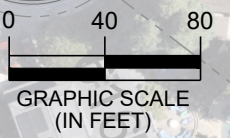

\\delucchi\p\Engineering\Streets\Annual Curb and Gutter Replacement CIP-25509\Drawings\CA\DCIP-25509_Paseo and Valley Area 2.dwg(12-23-24 12:39pm snguyen)

REV.	DATE	DESCRIPTION



CITY OF PLEASANTON
 PUBLIC WORKS DEPARTMENT

ADAM M. NELKIE
 CITY ENGINEER
 NO. 78830
 EXP. 9/30/25

ANNUAL CURB AND GUTTER FOR STREET RESURFACING PROJECT
 CALLE DE LA LOMA AND HANSEN DRIVE

DESIGN:	SN	SCALE:	AS SHOWN	DWG NO.
DRAWN:	SN	PROJECT NO.:	CIP-25509	A2-4
CHECKED:	GP	DATE:	DEC 23, 2024	14 OF 19
TRAFFIC ENGINEER:	MT			

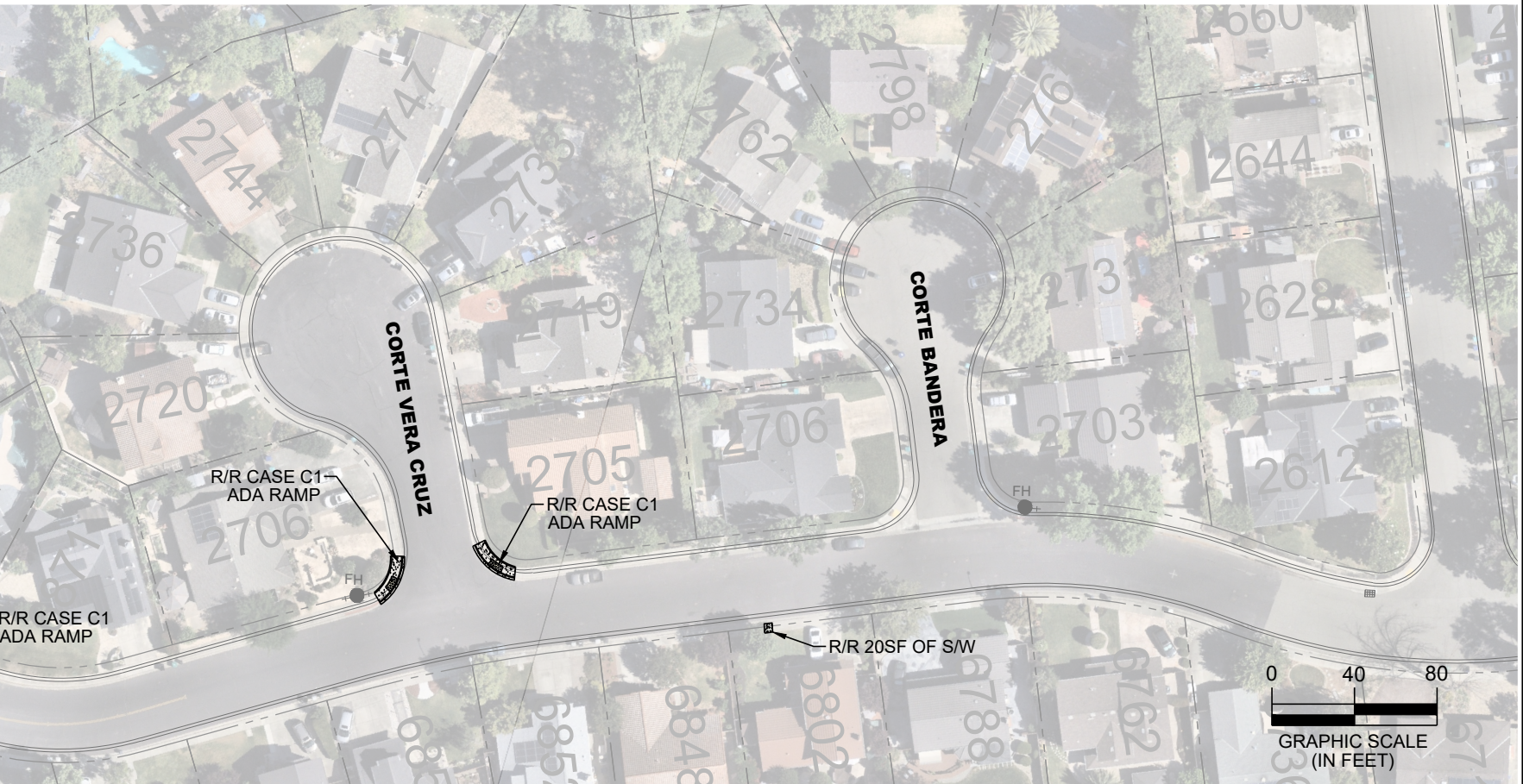
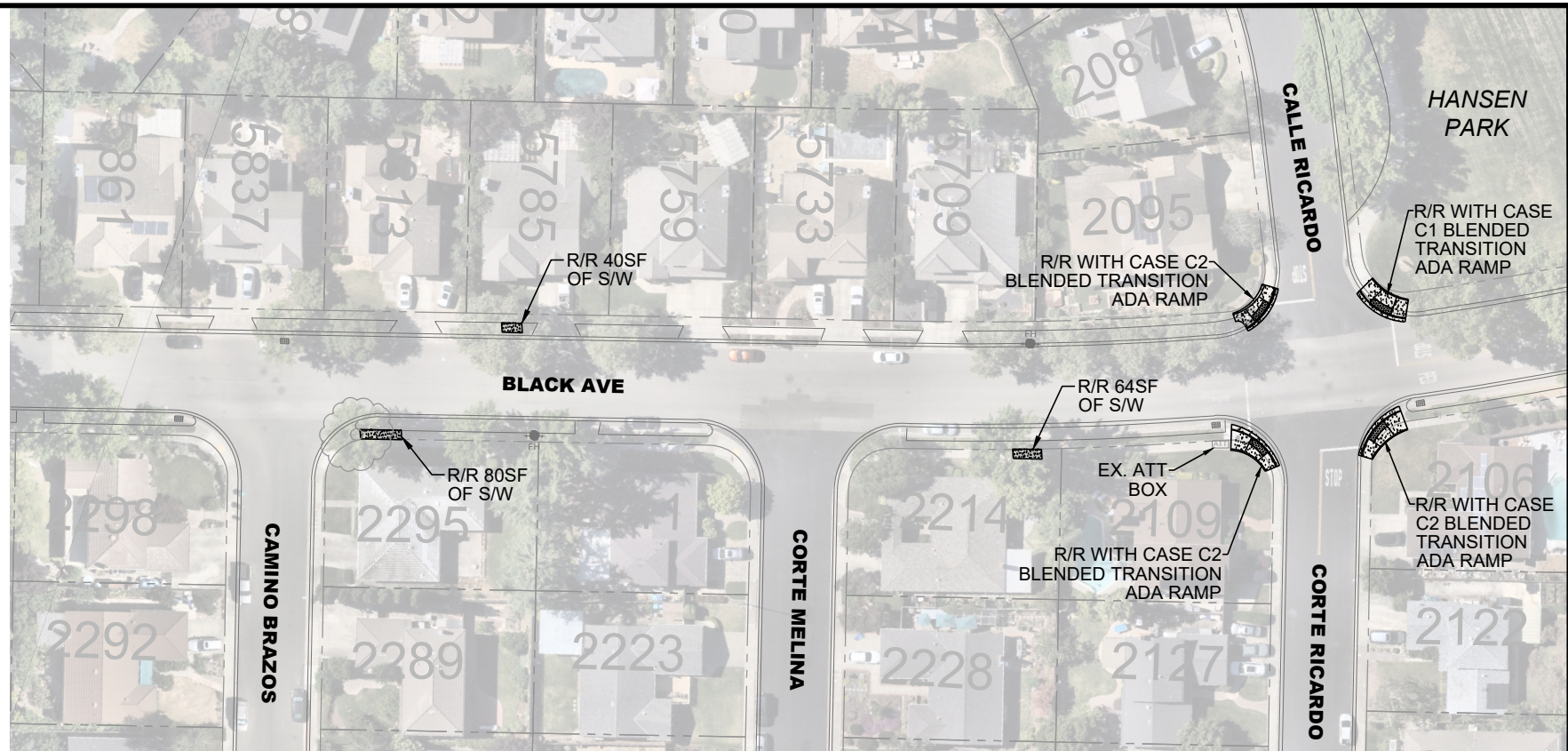
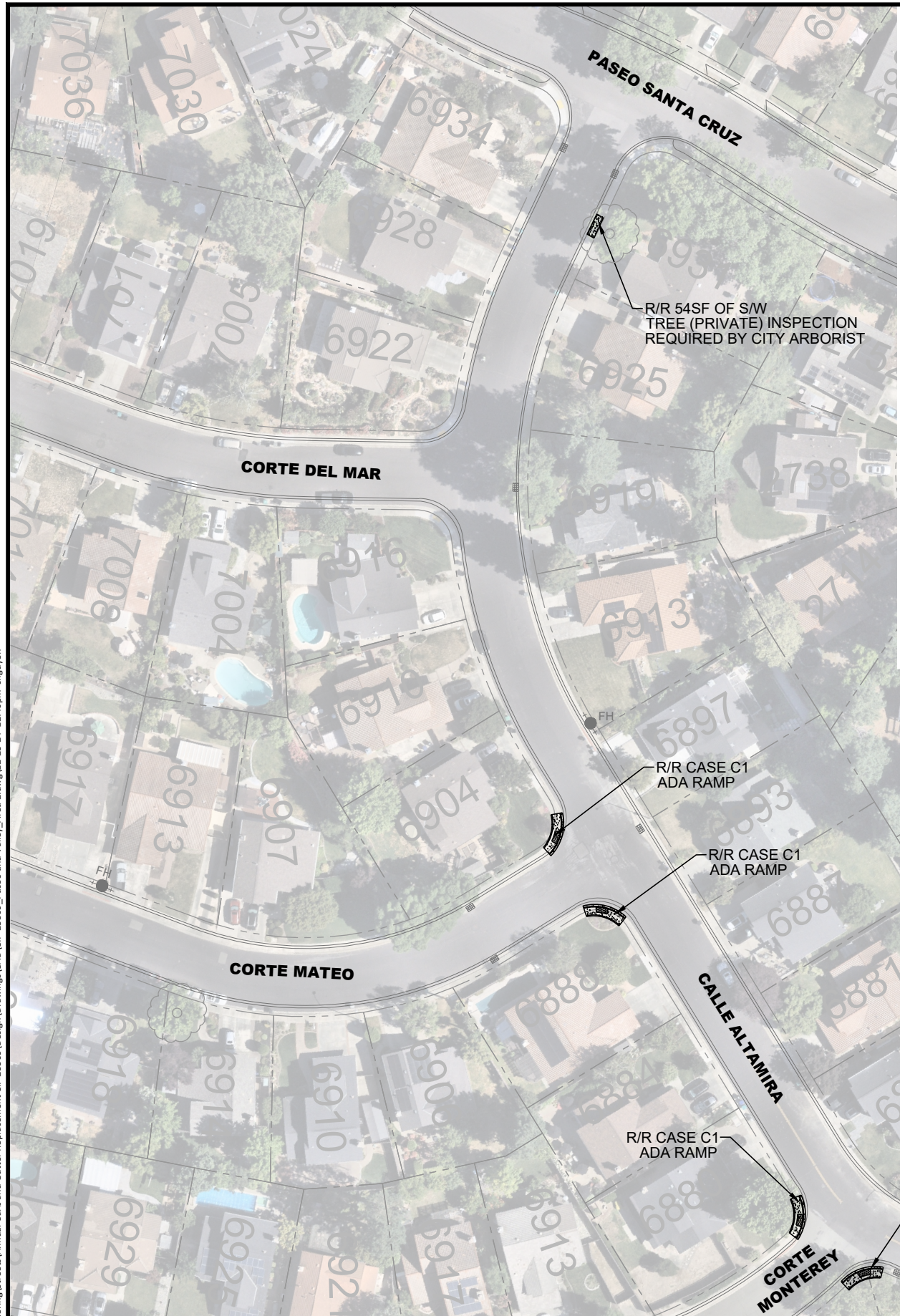
\\delucchi\pww\Engineering\Streets\Annual Curb and Gutter Replacement CIP 25509\Design\Drawings\CA\CP-25509_Paseo and Valley Area 2.dwg(12-23-24 12:40pm snguyen



REV.	DATE	DESCRIPTION

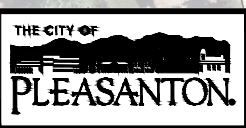

CITY OF PLEASANTON
PUBLIC WORKS DEPARTMENT

ADAM M. NELKIE
CITY ENGINEER
NO. 78830
EXP. 9/30/25

ANNUAL CURB AND GUTTER FOR STREET RESURFACING PROJECT
BLACK AVENUE, CALLE ALTAMIRA AND CORTE MATEO

DESIGN: SN
DRAWN: SN
CHECKED: GP
TRAFFIC ENGINEER: MT

SCALE: AS SHOWN
PROJECT NO.: CIP-25509
DATE: DEC 23, 2024

DWG NO. **A2-5**
15 OF 19

\\delucchi\p\engineering\streets\Annual Curb and Gutter Replacement\GP-25509\Drawings\CA\GP-25509_Gibraltar_Area 3.dwg 12-23-24 12:47pm sunguyen

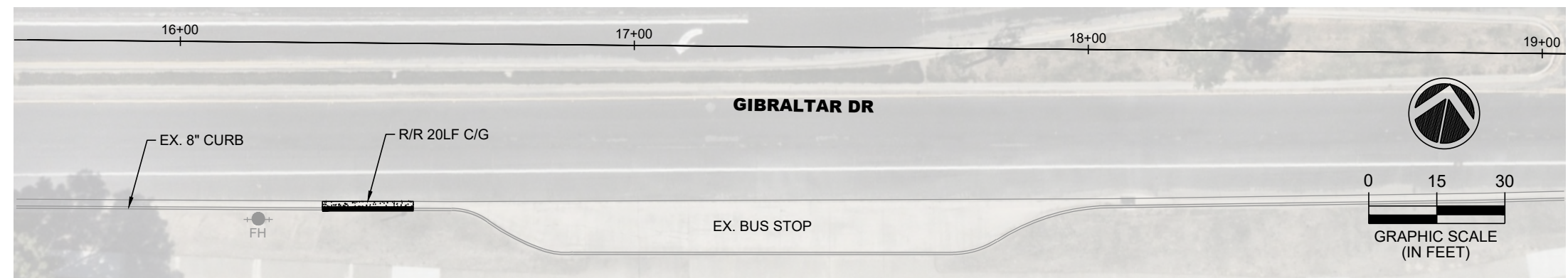
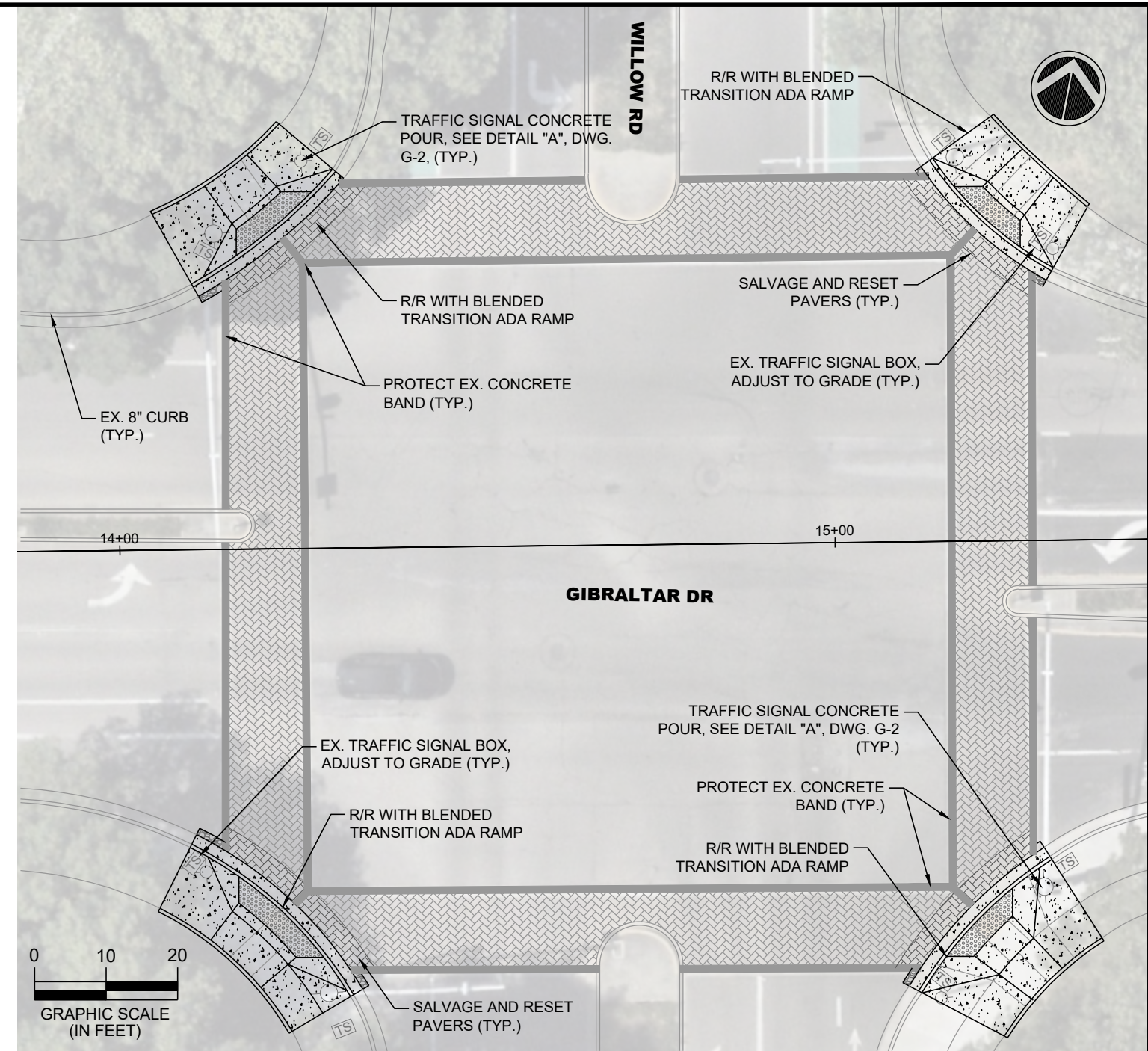
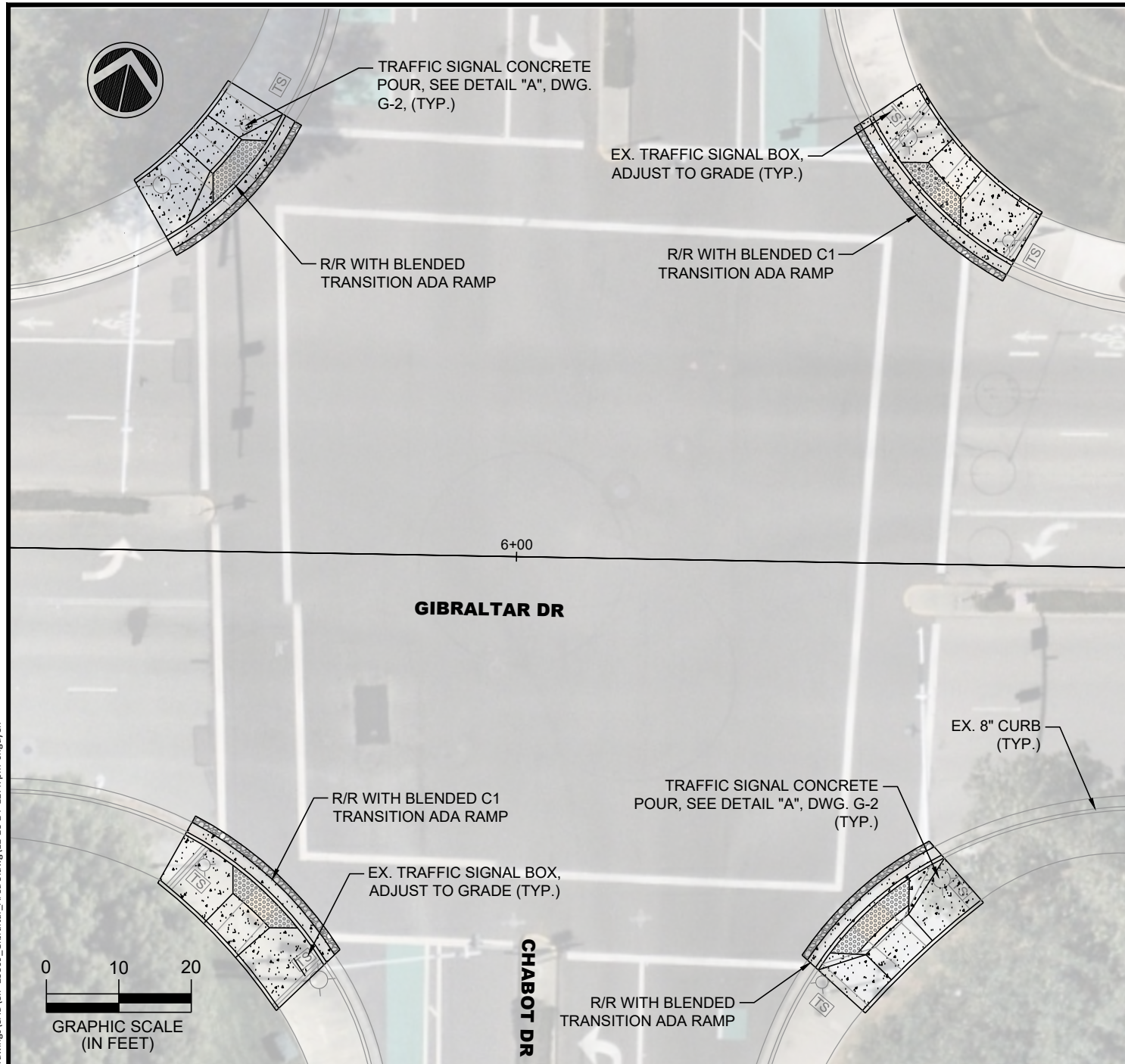

REV.	DATE	DESCRIPTION



CITY OF PLEASANTON
 PUBLIC WORKS DEPARTMENT

ADAM M. NELKIE
 CITY ENGINEER
 NO. 78830
 EXP. 9/30/25

ANNUAL CURB AND GUTTER FOR STREET RESURFACING PROJECT
GIBRALTAR DRIVE

DESIGN:	SN	SCALE:	AS SHOWN	DWG NO.
DRAWN:	SN	PROJECT NO.:	CIP-25509	A3-1
CHECKED:	GP	DATE:	DEC 23, 2024	16 OF 19
TRAFFIC ENGINEER:	MT			

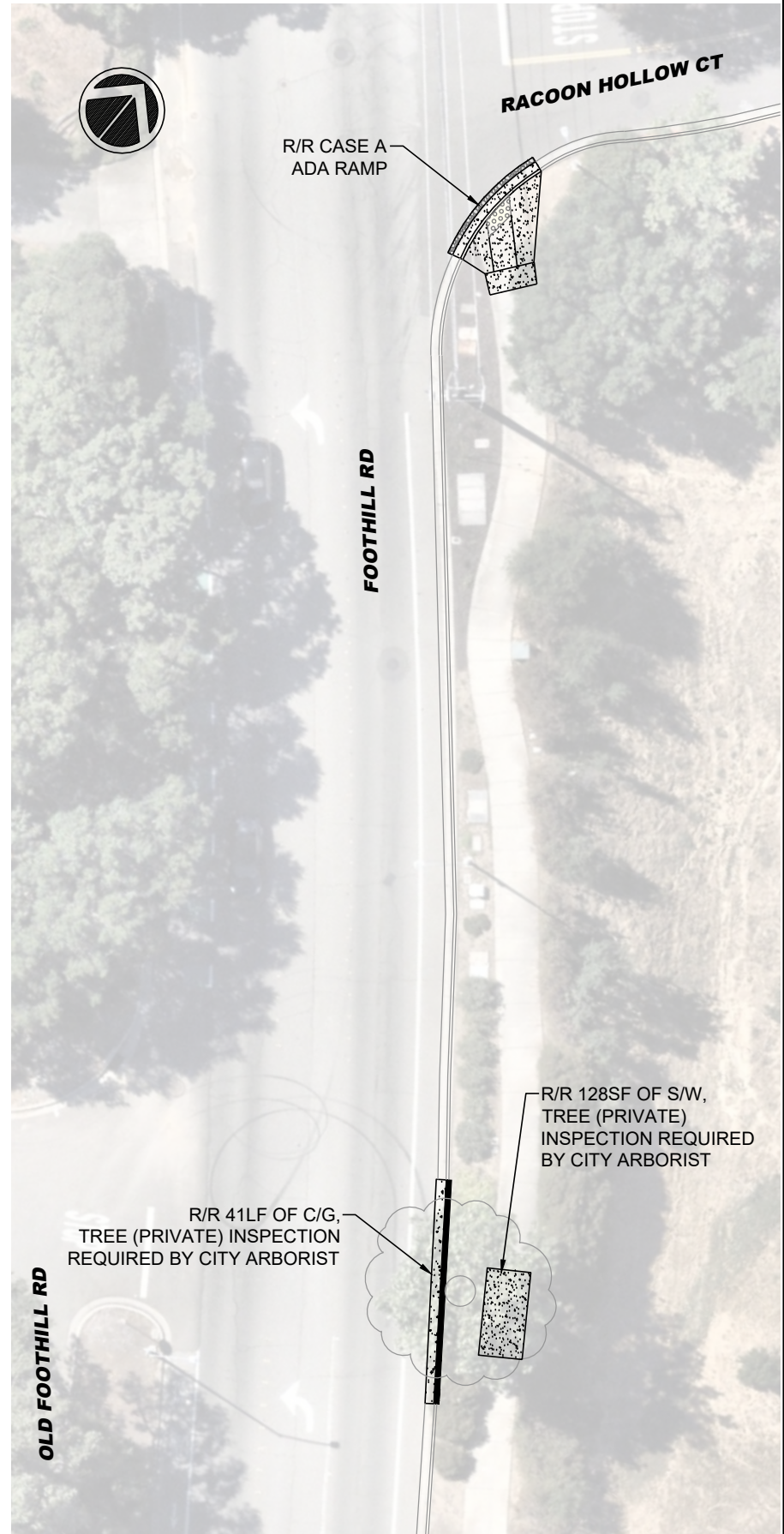
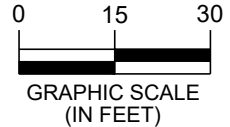
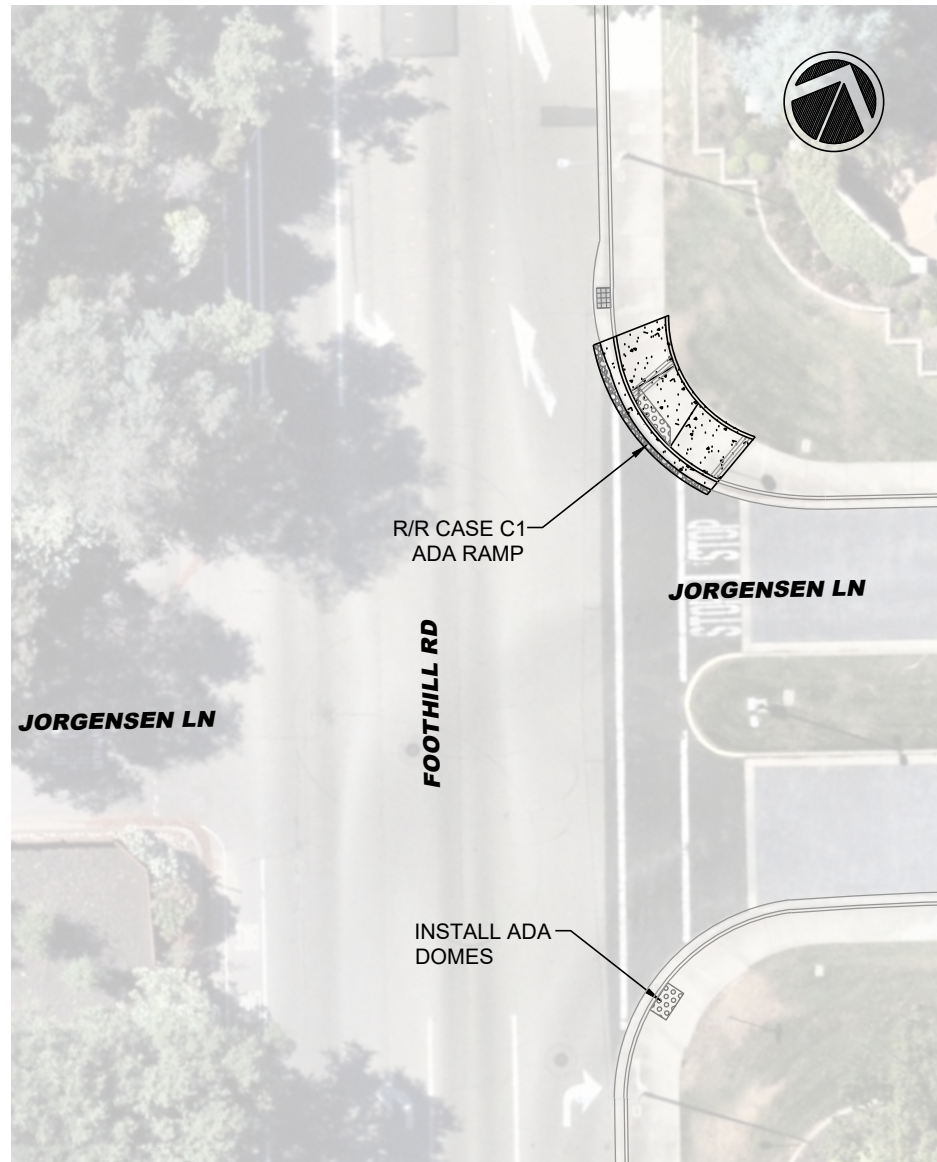
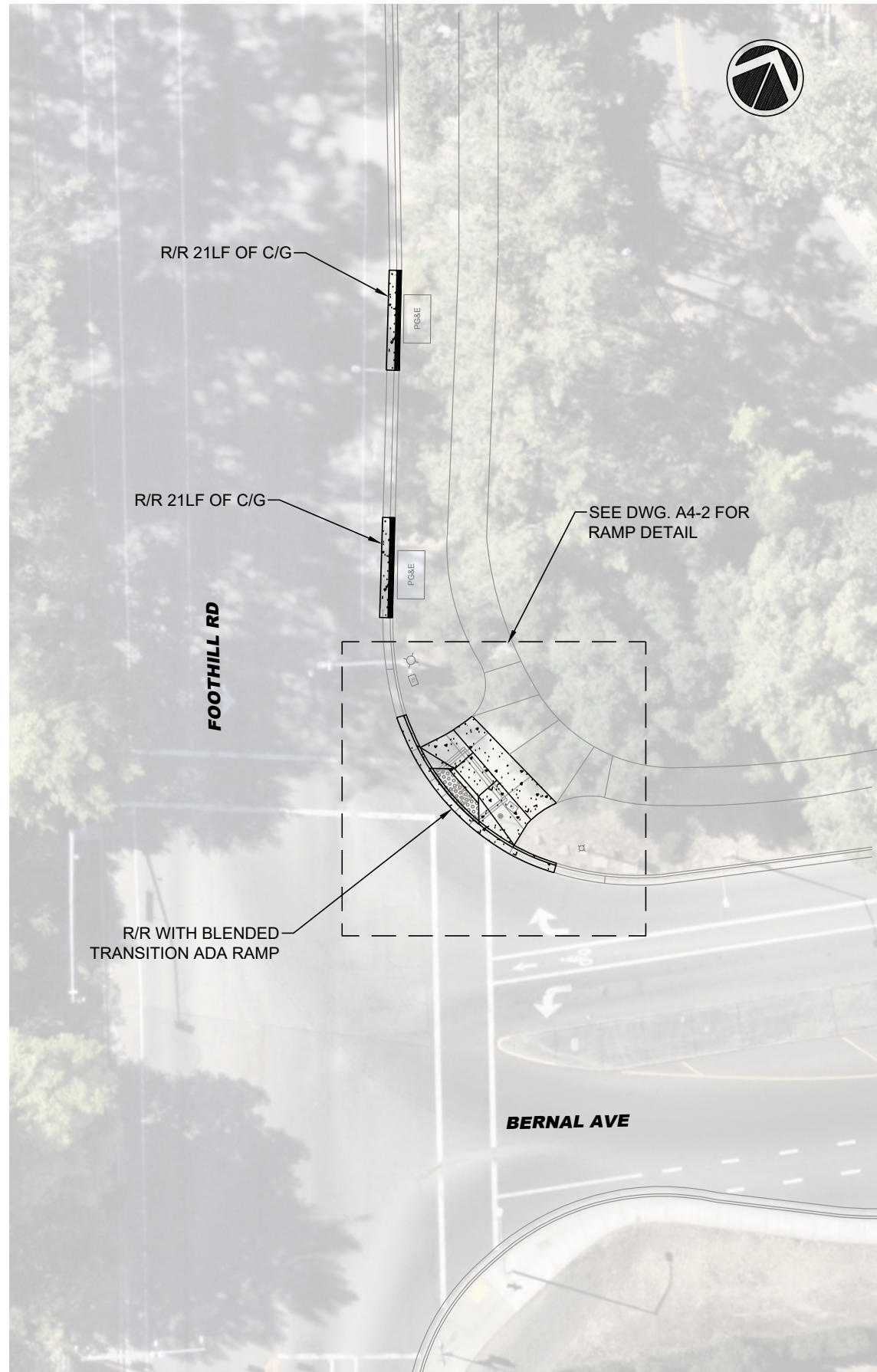
\\delucchi\p\engineering\Streets\Annual Curb and Gutter Replacement\Drawings\CAD\CIP-25509_Foothill_Area.dwg,12-23-24 12:55pm snguyen



REV.	DATE	DESCRIPTION

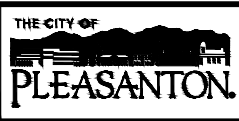

CITY OF PLEASANTON
PUBLIC WORKS DEPARTMENT

ADAM M. NELKIE
CITY ENGINEER
NO. 78830
EXP. 9/30/25

ANNUAL CURB AND GUTTER FOR STREET RESURFACING PROJECT
FOOTHILL ROAD

DESIGN: SN
DRAWN: SN
CHECKED: GP
TRAFFIC ENGINEER: MT

SCALE: AS SHOWN
PROJECT NO.: CIP-25509
DATE: DEC 23, 2024

DWG NO. **A4-1**
17 OF 19



FOOTHILL RD

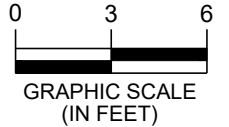

\\delucchi\p\Engineering\Streets\Annual Curb and Gutter Replacement CP 25509\Drawings\CAD\CIP-25509_Foothill Ramp Detail_Area 4.dwg 12-23-24 12:58pm nguyuen

REV.	DATE	DESCRIPTION	<p>CITY OF PLEASANTON PUBLIC WORKS DEPARTMENT</p>	<p>ADAM M. NELKIE CITY ENGINEER NO. 78830 EXP. 9/30/25</p>	<p>ANNUAL CURB AND GUTTER FOR STREET RESURFACING PROJECT</p> <p>FOOTHILL ROAD RAMP DETAIL</p>	DESIGN: SN	SCALE: AS SHOWN	DWG NO.
						DRAWN: SN	PROJECT NO.: CIP-25509	A4-2
						CHECKED: GP	DATE: DEC 23, 2024	18 OF 19
						TRAFFIC ENGINEER: MT		

\\delucchi\p\engineering\Streets\Annual Curb and Gutter Replacement CIP-25509\Design\Drawings\CAD\CIP-25509_Commerce Circle_Area 5.dwg 12/23/24 12:59pm snguyen

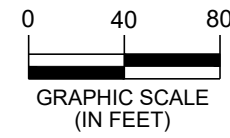
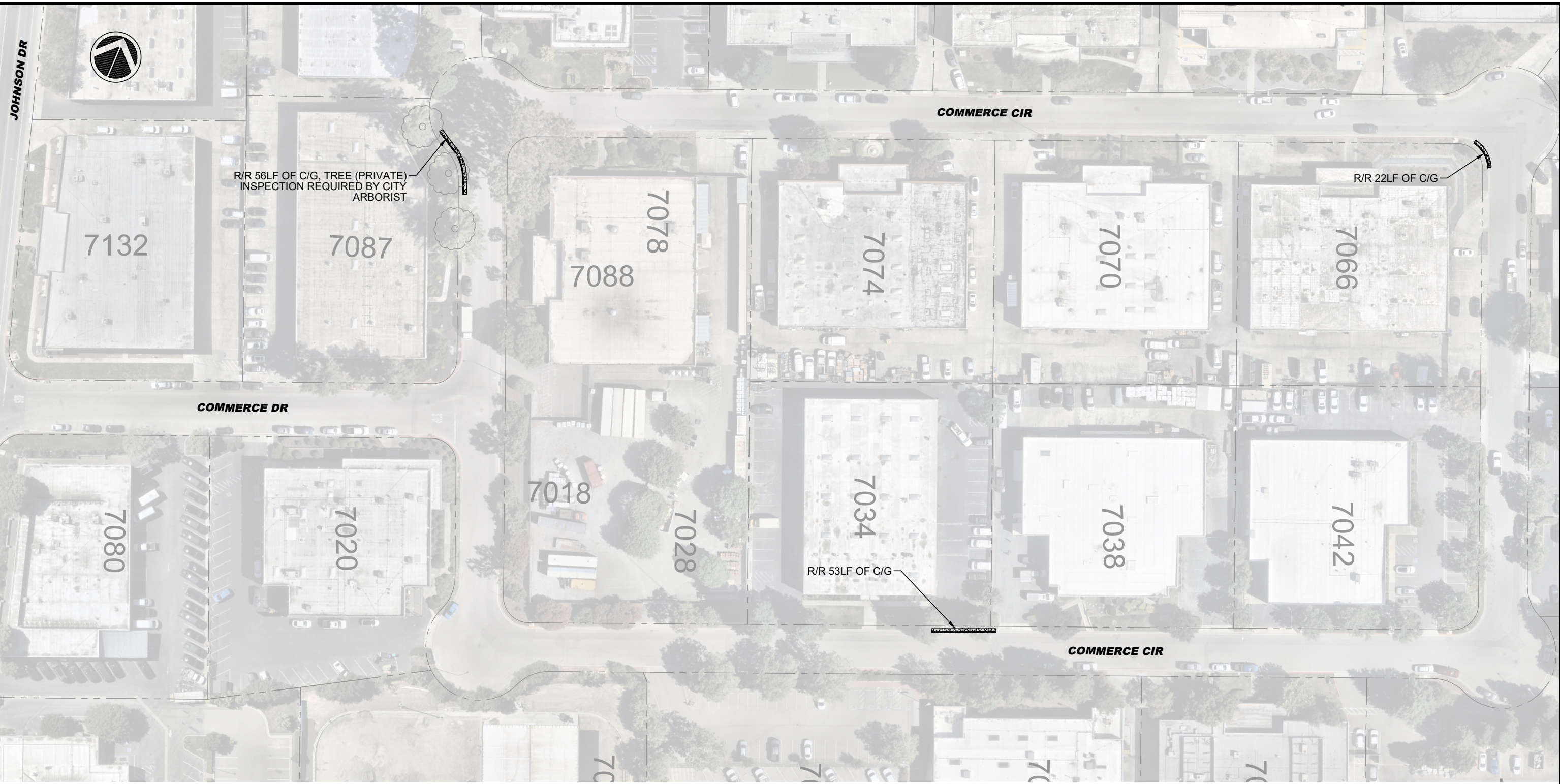

REV.	DATE	DESCRIPTION



CITY OF PLEASANTON
PUBLIC WORKS DEPARTMENT

ADAM M. NELKIE
CITY ENGINEER
NO. 78830
EXP. 9/30/25

ANNUAL CURB AND GUTTER FOR STREET RESURFACING PROJECT
COMMERCE CIRCLE

DESIGN: SN
DRAWN: SN
CHECKED: GP
TRAFFIC ENGINEER: MT

SCALE: AS SHOWN
PROJECT NO.: CIP-25509
DATE: DEC 23, 2024

DWG NO. **A5-1**
19 OF 19